



Door



Profile

Dolphin Metal Products Co., LTD

Email: sales@fsdolphin.com

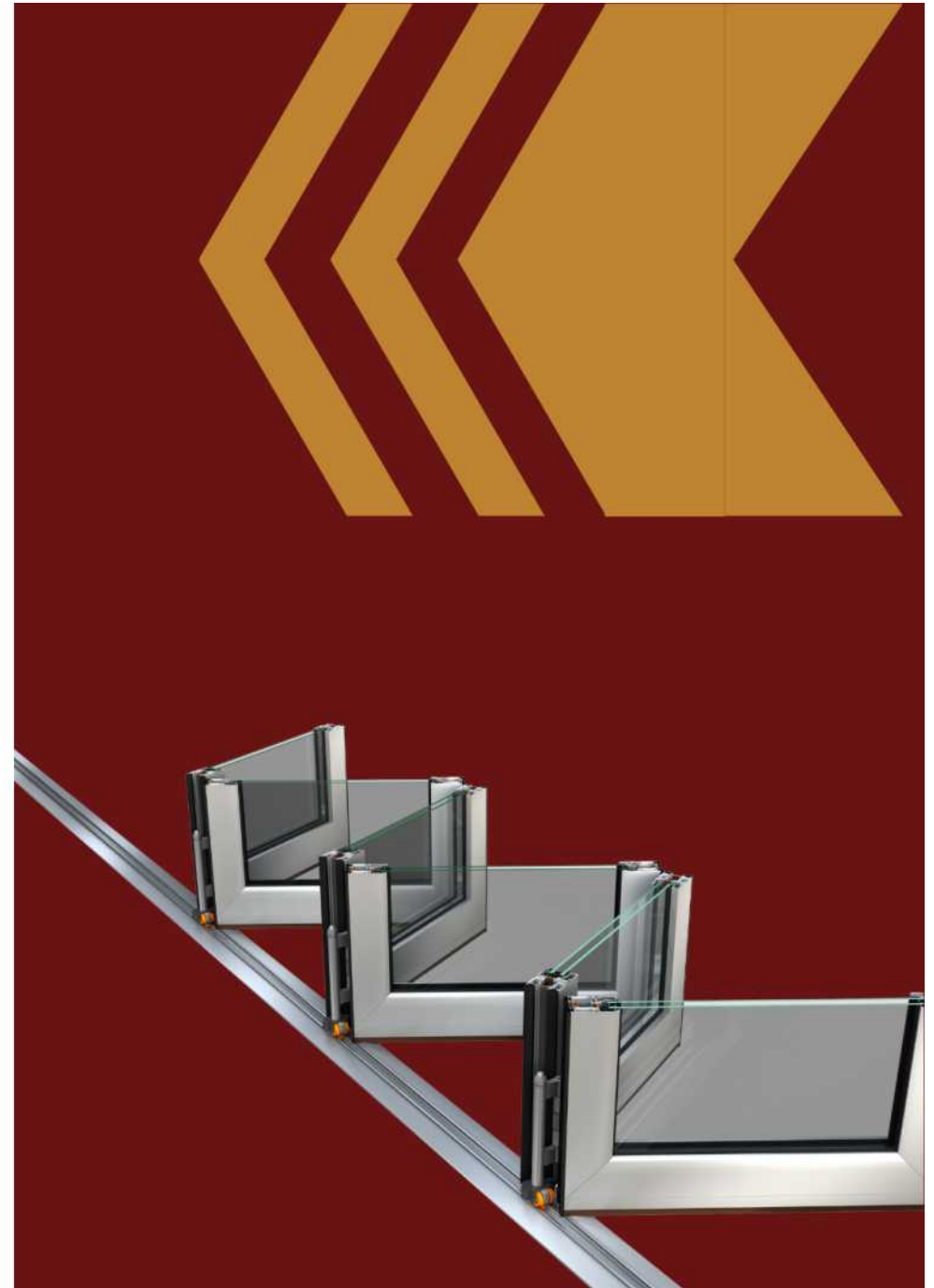

| 产品编号 | 产品图例 | 产品编号 | 产品图例 | 产品编号 | 产品图例 |
|--|------|--|------|---|------|
| XHY5001 T=1.4mm 0.749kg/m 配压线: XHY5004 XHY5004A XHY5005 XHY5005A | | XHY5002 T=1.4mm 1.126kg/m | | XHY5003 T=1.4mm 0.916kg/m 配压线: XHY5004 XHY5004A XHY5005 XHY5005A | |
| 外框 | | 窗料 | | 中框 | |
| XHY5004 T=1.0mm 0.184kg/m 配: XHY5001 XHY5021H 玻璃口: 26mm | | XHY5004A T=1.0mm 0.175kg/m 配: XHY5001 XHY5021H 玻璃口: 26mm | | XHY5005 T=1.1mm 0.155kg/m 配: XHY5003 XHY5023H 玻璃口: 26mm | |
| 压线 | | 压线 | | 压线 | |
| XHY5005A T=1.0mm 0.148kg/m 配: XHY5003 XHY5023H 玻璃口: 28mm | | XHY5021H T=2.0mm 1.053kg/m 配压线: XHY5004 XHY5004A XHY5005 XHY5005A | | XHY5022H T=2.0mm 1.906kg/m | |
| 压线 | | 外框 | | 窗料 | |
| XHY5023H T=2.0mm 1.184kg/m 配压线: XHY5004 XHY5004A XHY5005 XHY5005A | | XHY5024 T=1.4mm 0.775kg/m | | XHY5025 T=1.4mm 0.488kg/m 配压线: XHY5004 XHY5004A XHY5005 XHY5005A | |
| 中框 | | 框中框 | | 封条料 | |
| JN6413 T=1.4mm 0.302kg/m | | SM5014 T=2.0mm 0.609kg/m | | XHY5027 T=1.4mm 0.923kg/m 配压线: XHY5030 | |
| 门收边 | | 门框 | | 外框 | |
| XHY5028 T=1.4mm 1.124kg/m | | XHY5029 T=1.4mm 1.056kg/m 配压线: XHY5030 | | XHY5030 T=1.0mm 0.198kg/m 配: XHY5027 XHY5029 XHY5033 玻璃口: 28.8mm | |
| 扇料 | | 中框 | | 压线 | |
| XHY5031 T=1.2mm 0.168kg/m 玻璃口: 28.8mm | | XHY5032 T=1.4mm 0.939kg/m 配压线: XHY5030 | | XHY5037 T=2.0mm 1.407kg/m 配压线: XHY5004 | |
| 压线 | | 框中框 | | 中框 | |
| XHY5033 T=2.0mm 1.440kg/m 配压线: XHY5030 角钢配: JNA5006 | | XHY5001 | | XHY5005A | |
| 外框 | | XHY5004 | | XHY5023H | |
| XHY5027 | | | | | |
| XHY5030 | | | | | |

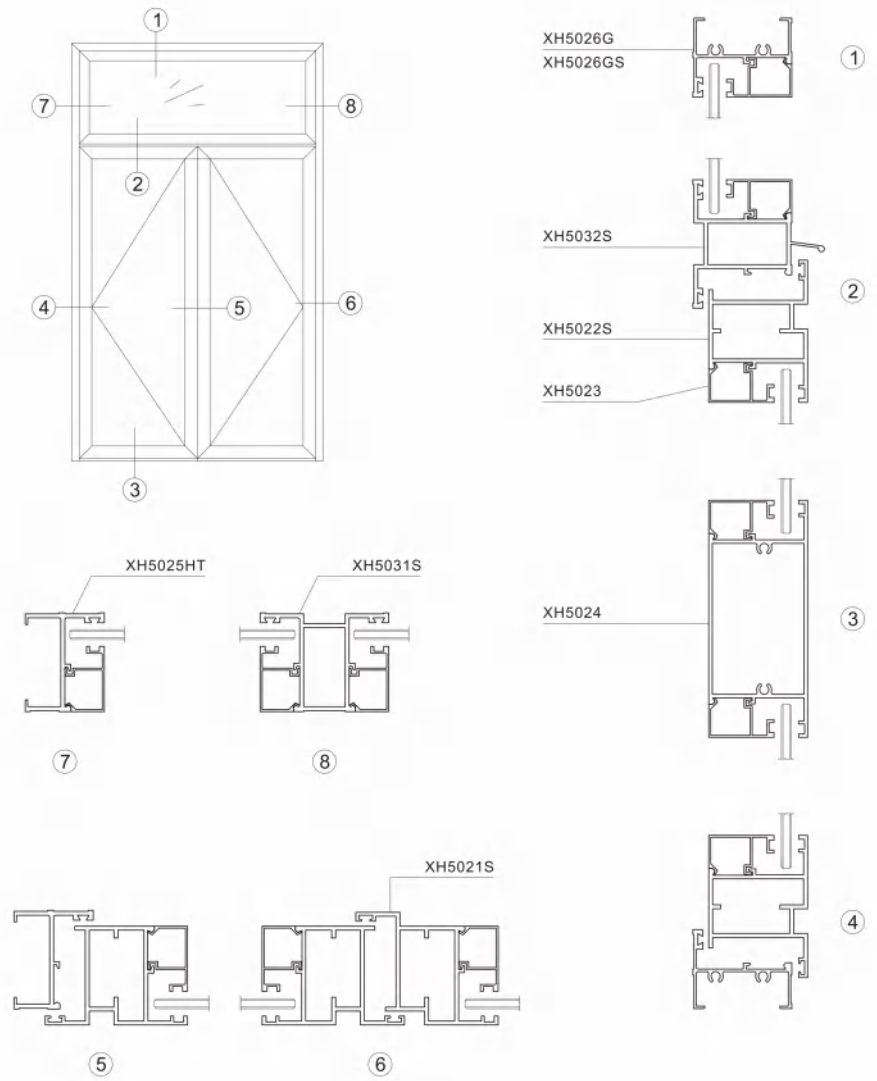

| 产品编号 | 产品图例 | 产品编号 | 产品图例 | 产品编号 | 产品图例 |
|--|------|--|------|--|------|
| XH5025 T=1.2mm 0.501kg/m XH5025H T=1.6mm 0.600kg/m XH5025T T=1.4mm 0.555kg/m XH5025HT T=2.0mm 0.897kg/m 外框 | | XH5021 T=1.2mm 0.899kg/m 角码配: XH5029 XH5021T T=1.4mm 0.948kg/m 角码配: XH5029 XH5021S T=2.0mm 1.307kg/m 角码配: XH5029 门扇 | | XH5026G T=1.2mm 0.619kg/m XH5026GH T=1.6mm 0.695kg/m XH5026GS T=2.0mm 0.808kg/m XH5026GT T=1.4mm 0.641kg/m 外框 | |
| XH5031 T=1.2mm 0.851kg/m XH5031T T=1.4mm 0.906kg/m XH5031S T=2.0mm 1.158kg/m 中框 | | XH5030A T=1.4mm 0.884kg/m 角码配: XH5029B 中框 | | XH5031AT T=1.4mm 0.981kg/m 中框 | |
| XH5030 T=1.2mm 0.754kg/m 角码配: XH5029A XH5030T T=1.4mm 0.834kg/m 角码配: XH5029B XH5030S T=2.0mm 1.041kg/m 角码配: ZJ5041 中框 | | XH5032 T=1.2mm 0.918kg/m XH5032T T=1.4mm 0.968kg/m XH5032S T=2.0mm 1.225kg/m 中框 | | XH5022 T=1.2mm 0.899kg/m 角码配: XH5029 XH5022T T=1.4mm 0.951kg/m 角码配: XH5029 XH5022S T=2.0mm 1.300kg/m 角码配: XH5029 内扇 | |
| XH50119 T=1.2mm 0.820kg/m 角码配: XH5029 内扇 | | XH5024 T=1.6mm 1.539kg/m XH5024P T=1.4mm 1.346kg/m 门中框 | | XH5034 T=1.5mm 0.901kg/m 型材 | |
| XH5033 T=1.8mm 1.559kg/m 门中框 | | XH5035 T=1.0mm 0.288kg/m 压线(中空) | | XH5098B T=1.4mm 0.951kg/m 135°转角 | |
| XH5023B T=1.0mm 0.202kg/m 压线(中空) | | XH5059 T=1.4mm 1.127kg/m 90°转角 | | XH5035B T=1.0mm 0.197kg/m 压线(中空) | |
| XH5023A T=1.0mm 0.220kg/m 压线(单嵌) | | XH5027 T=1.3mm 0.561kg/m 纱窗 | | XH5035A T=1.0mm 0.187kg/m 压线(中空) | |
| XH5028 T=1.3mm 0.618kg/m 纱中框 | | XH5023 T=1.0mm 0.259kg/m 压线(单嵌) | | XH5023 XH5030 | |
| | | | | | |

| 产品编号 | 产品图例 | 产品编号 | 产品图例 | 产品编号 | 产品图例 |
|------|------|------|------|------|------|
| | | | | | |
| | | | | | |
| | | | | | |
| | | | | | |
| | | | | | |
| | | | | | |
| | | | | | |
| | | | | | |
| | | | | | |
| | | | | | |
| | | | | | |



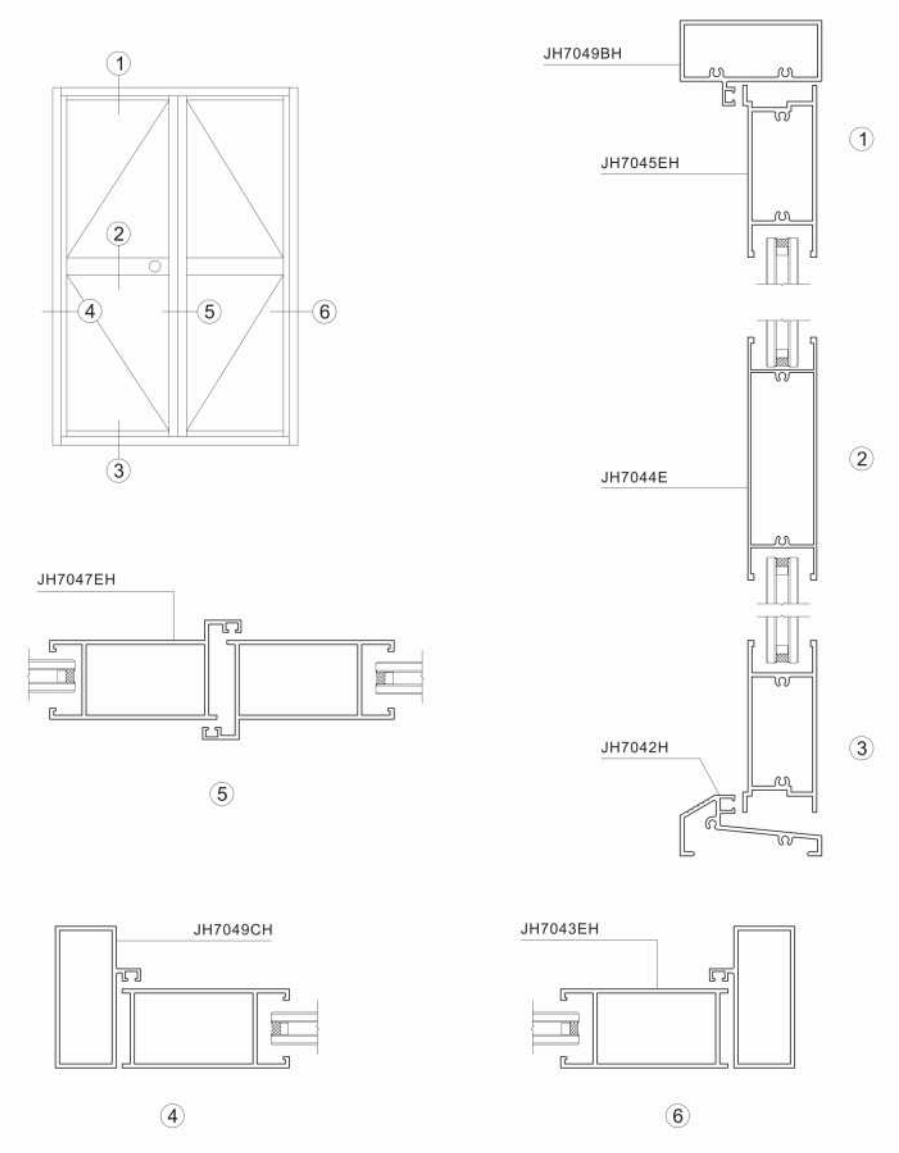
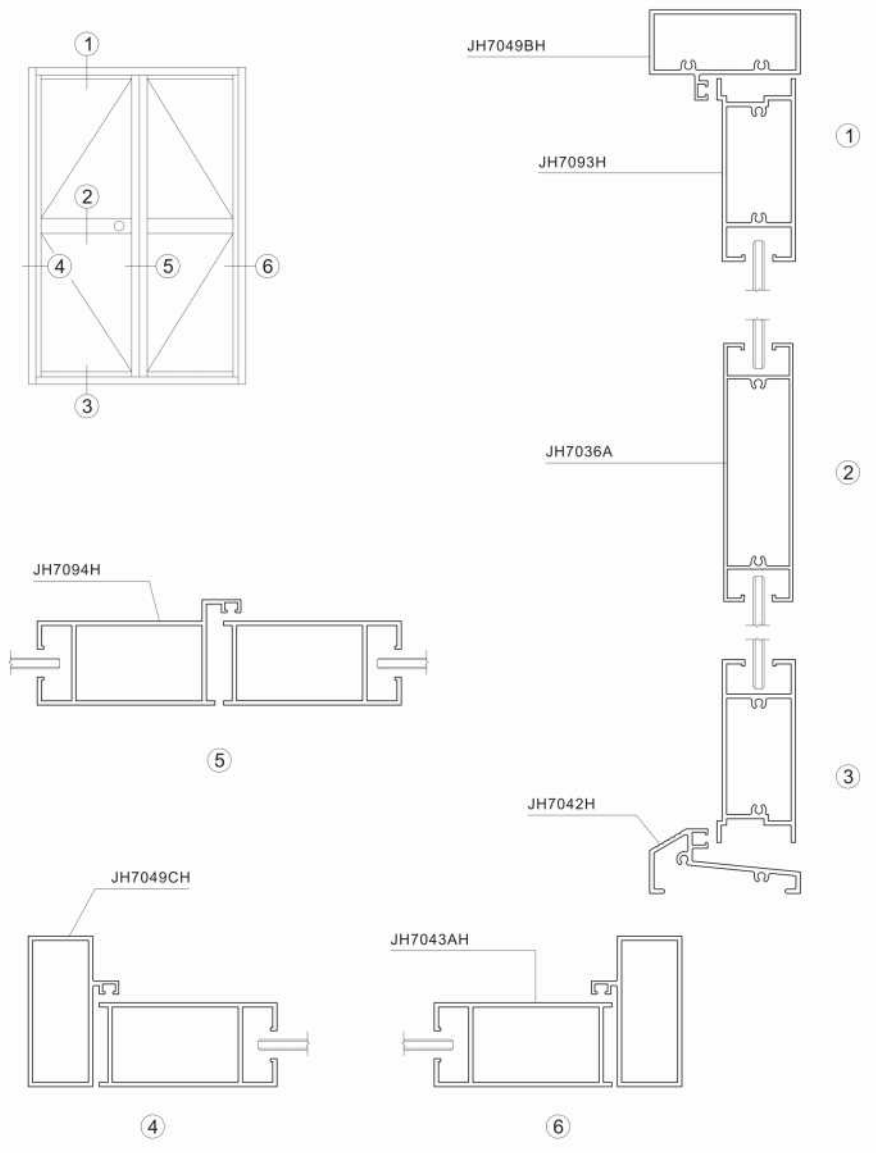

| 产品编号 | 产品图例 | 产品编号 | 产品图例 | 产品编号 | 产品图例 |
|-------------------------------|------|--------------------------------|------|--------------------------------|------|
| JH7041 T=1.3mm 0.675kg/m | | JH7041Z T=1.4mm 0.443kg/m | | JH7041L T=1.3mm 1.046kg/m | |
| JH7041T T=1.7mm 0.819kg/m | | | | JH7041LT T=1.7mm 1.272kg/m | |
| JH7041H T=2.0mm 0.928kg/m | | 外框 | | 中柱 | |
| JH7041M T=1.4mm 0.481kg/m | | JH7042Z T=1.3mm 0.913kg/m | | JH7042 T=1.3mm 0.624kg/m | |
| | | 余料 | | JH7042H T=2.0mm 0.833kg/m | |
| JH7049B T=1.4mm 0.941kg/m | | JH7048 T=1.3mm 0.579kg/m | | JH7049 T=1.3mm 0.780kg/m | |
| JH7049BH T=2.0mm 1.233kg/m | | JH7048T T=1.7mm 0.725kg/m | | JH7049T T=1.7mm 0.983kg/m | |
| | | JH7048H T=1.8mm 0.765kg/m | | JH7049H T=1.85mm 1.063kg/m | |
| | | JH7048HT T=2.0mm 0.842kg/m | | JH7049CH T=2.0mm 1.139kg/m | |
| JH7047C T=1.4mm 1.132kg/m | | JH7036A T=1.5mm 1.461kg/m | | JH7043EH T=2.0mm 1.341kg/m | |
| | | 配: JH7043C | | | |
| | | 毛企(单玻) | | | |
| JH7045EH T=2.0mm 1.400kg/m | | JH7043HZK T=2.0mm 1.363kg/m | | JH7043H T=2.0mm 1.430kg/m | |
| | | 配: JH7043EH | | | |
| | | 中空(单玻) | | | |
| JH7043C T=1.4mm 1.005kg/m | | JH7047EH T=2.0mm 1.474kg/m | | JH7047H T=2.0mm 1.512kg/m | |
| JH7043AH T=2.0mm 1.406kg/m | | | | | |
| | | 边企(单玻) | | | |
| JH7044E T=1.4mm 1.281kg/m | | JH70102H T=2.0mm 1.381kg/m | | JH7043CA T=1.4mm 0.978kg/m | |
| | | 配: JH7043EH | | JH7043HZK T=2.0mm 1.363kg/m | |
| | | 28上下横(中空) | | | |
| JH7093H T=2.0mm 1.490kg/m | | JH7045FZK T=2.0mm 1.410kg/m | | JH7045CA T=1.4mm 1.051kg/m | |
| | | | | | |
| | | 28中横(中空) | | | |
| JH7045HF T=2.0mm 1.453kg/m | | JH7094H T=2.0mm 1.572kg/m | | | |
| | | | | | |
| | | 上下横(单玻) | | | |
| | | 上下横(中空) | | | |
| | | 上下横(单玻) | | | |
| | | 上下横(中空) | | | |

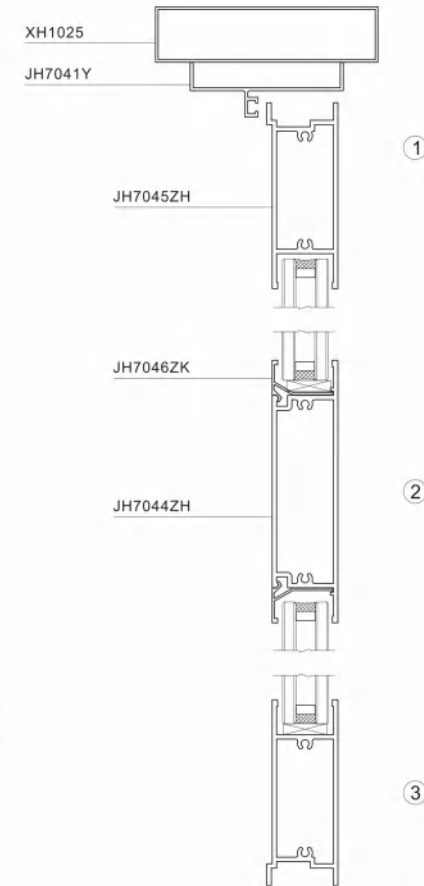
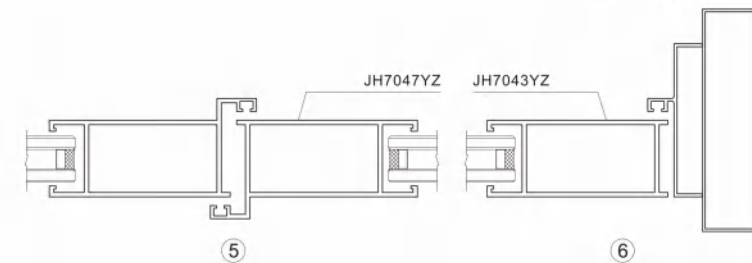
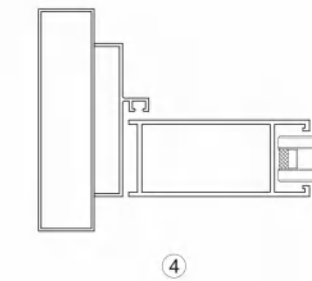
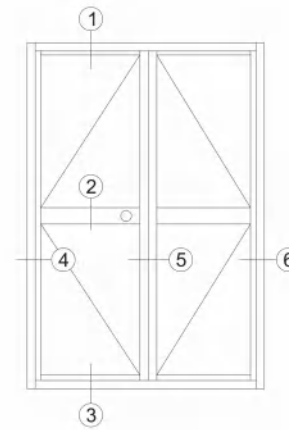

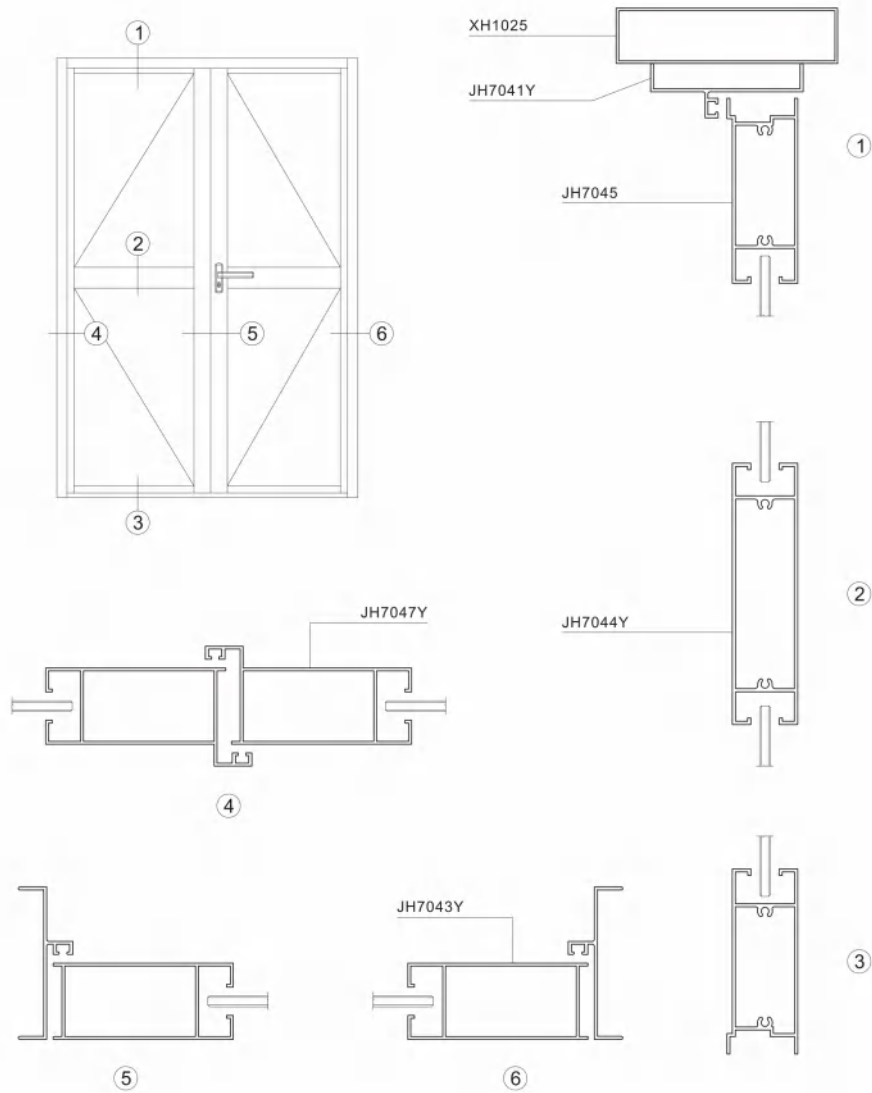

| 产品编号 | 产品图例 | 产品编号 | 产品图例 | 产品编号 | 产品图例 |
|--|------|---|------|---|------|
| JH7063A T=1.4mm 0.790kg/m JH7063AT T=1.5mm 0.842kg/m | | JH7041Y T=1.4mm 0.443kg/m | | JH7043 T=1.3mm 0.640kg/m JH7043T T=1.7mm 0.818kg/m JH7043H T=2.0mm 0.940kg/m | |
| JH7044Y T=1.5mm 1.428kg/m JH7044YP T=1.2mm 1.198kg/m JH7044YH T=2.0mm 1.840kg/m | | JH7047 T=1.3mm 0.752kg/m JH7047T T=1.7mm 0.968kg/m JH7047H T=2.0mm 1.109kg/m | | JH7043Y T=1.3mm 0.894kg/m JH7043YH T=2.0mm 1.357kg/m | |
| JH7047Y T=1.3mm 1.018kg/m JH7047YH T=2.0mm 1.490kg/m | | JH7045 T=1.4mm 1.036kg/m JH7045T T=1.7mm 1.225kg/m JH7045P T=1.2mm 0.907kg/m JH7045H T=2.0mm 1.409kg/m | | JH7043ZK T=1.3mm 0.597kg/m | |
| JH7043YZ T=2.0mm 1.278kg/m | | JH7047ZK T=1.3mm 0.728kg/m | | JH7047YZ T=2.0mm 1.425kg/m | |
| JH7044EZK T=1.3mm 1.171kg/m | | JH7045ZK T=1.3mm 0.928kg/m | | JH7045ZH T=2.0mm 1.341kg/m | |
| JH7045O T=1.4mm 0.997kg/m | | JH7036D T=1.4mm 1.270kg/m | | JH7045C T=1.4mm 1.066kg/m | |
| JH7043YT T=2.0mm 1.364kg/m | | JH7043BT T=1.4mm 0.970kg/m | | JH7098 T=1.95mm 0.840kg/m | |
| JH7096 T=1.95mm 0.908kg/m | | JH7095 T=1.95mm 1.355kg/m | | JH70100 T=1.95mm 1.739kg/m | |
| JH7097 T=1.95mm 1.064kg/m | | JH7099 T=1.95mm 0.897kg/m | | JH70101 T=1.95mm 1.393kg/m | |



| 产品编号 | 产品图例 | 产品编号 | 产品图例 | 产品编号 | 产品图例 |
|-------------------------------|------|-------------------------------|------|----------|------|
| JH7044ZH T=2.0mm 1.584kg/m | | JH7046ZK T=1.0mm 0.144kg/m | | JH7044ZK | |
| 中横 | | 压线 | | | |
| | | | | | |
| | | | | | |
| | | | | | |
| | | | | | |
| | | | | | |
| | | | | | |
| | | | | | |
| | | | | | |
| | | | | | |

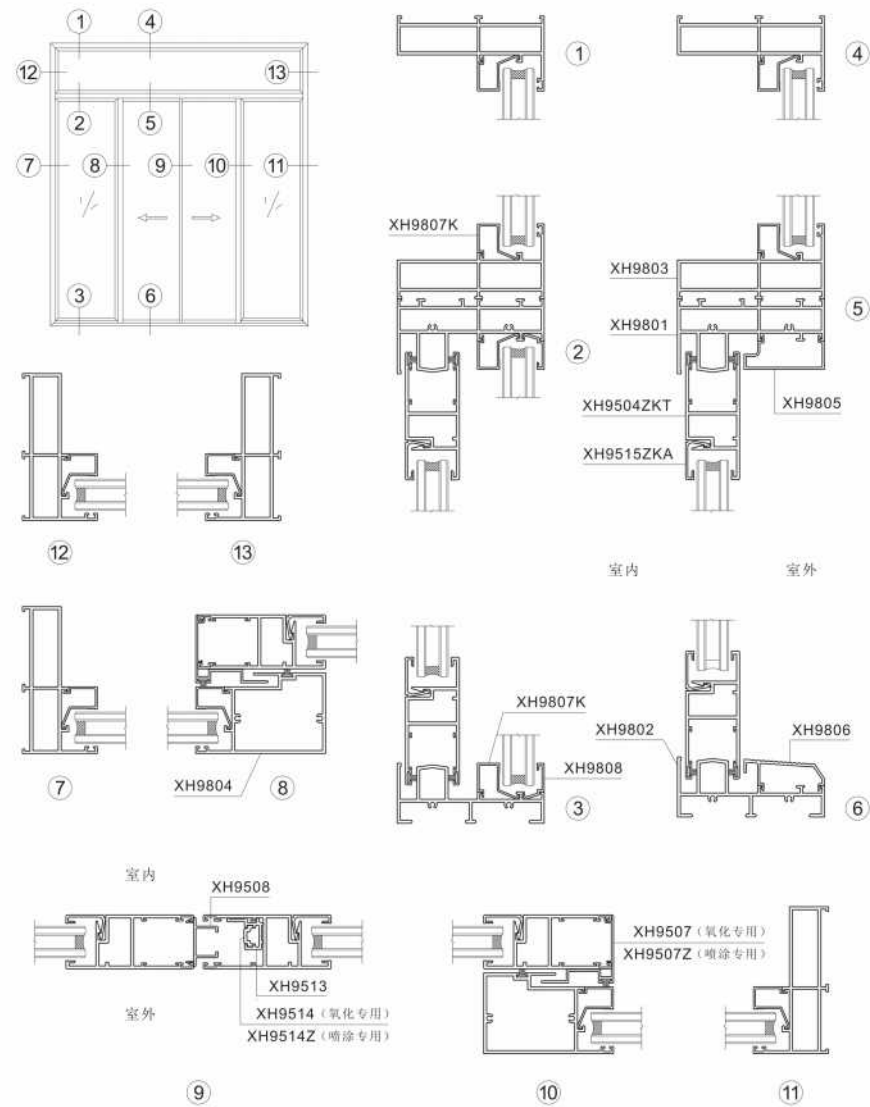

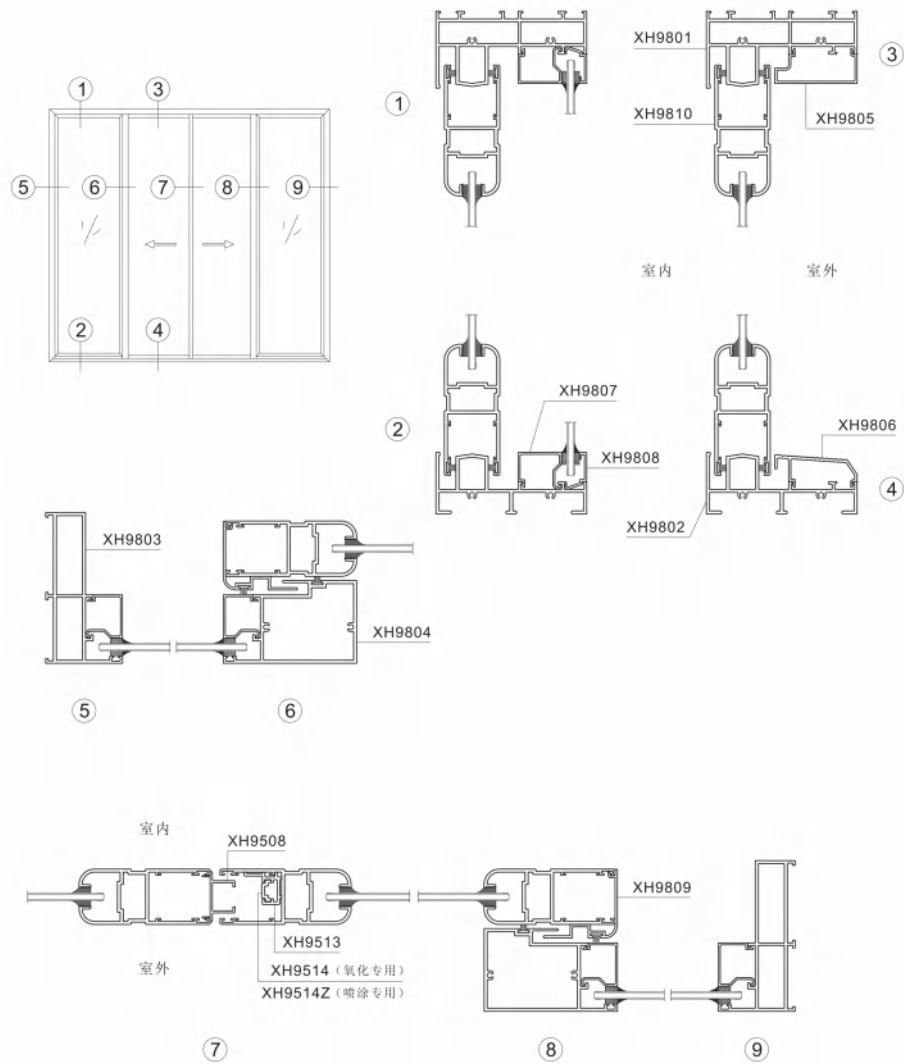

| 产品编号 | 产品图例 | 产品编号 | 产品图例 | 产品编号 | 产品图例 |
|---|------|------------------------------|------|--|------|
| XH9801 T=2.0mm 2.131kg/m | | XH9802 T=2.0mm 1.491kg/m | | XH9803 T=2.0mm 1.630kg/m | |
| 上轨 | | 上轨 | | 边封 | |
| XH9804 T=2.0mm 1.589kg/m 压线配: XH9807 XH9807K | | XH9805 T=1.4mm 0.410kg/m | | XH9806 T=1.6mm 0.423kg/m | |
| 勾企 | | 盖板 | | 盖板 | |
| XH9807 T=1.2mm 0.267kg/m | | XH9807K T=1.2mm 0.236kg/m | | XH9808 T=1.4mm 0.156kg/m | |
| 压线 | | 压线 | | 压线 | |
| XH9809 T=1.5mm 0.467kg/m | | XH9810 T=2.0mm 1.488kg/m | | XH9513 T=1.7mm 0.302kg/m | |
| 勾企 | | 扇料 | | 锁件 | |
| XH9514 (氧化专用) T=2.0mm 0.118kg/m XH9514Z (喷涂专用) T=2.0mm 0.114kg/m | | XH9508 T=1.4mm 0.279kg/m | | XH9504ZKT T=2.0mm 1.334kg/m 压线配: XH9515ZKA | |
| 锁件 | | 收口 | | 勾企 | |
| XH9515ZKA T=1.4mm 0.191kg/m | | XH9807 XH9804 | | XH9807K XH9804 | |
| 压线 | | | | | |
| | | | | | |
| | | | | | |
| | | | | | |



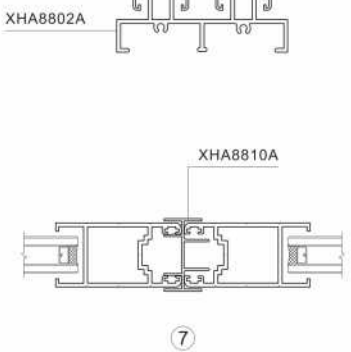
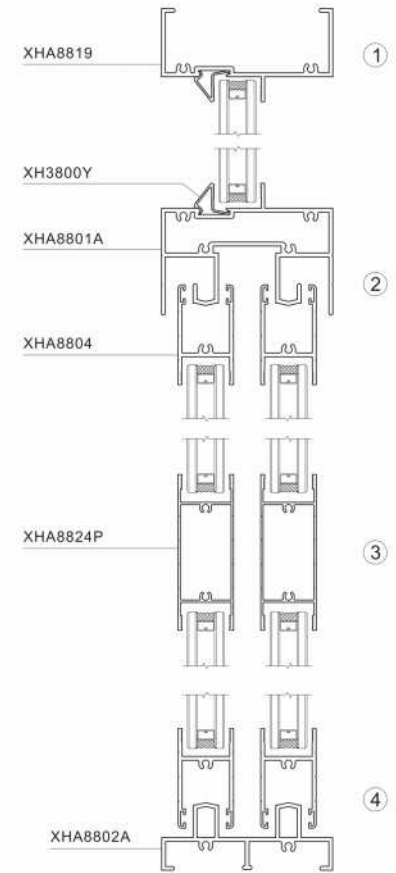
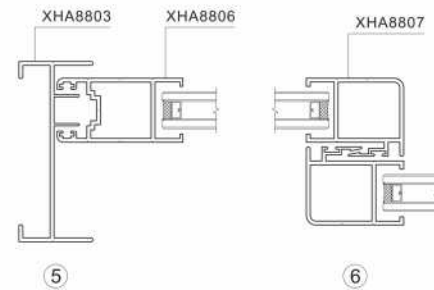
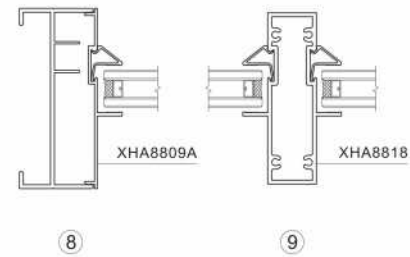
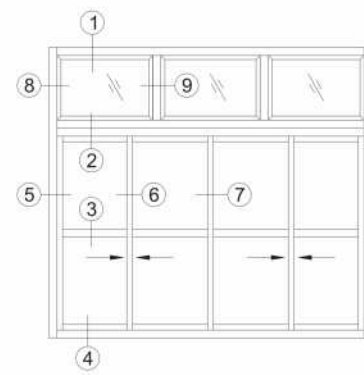
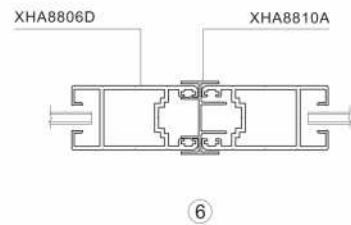
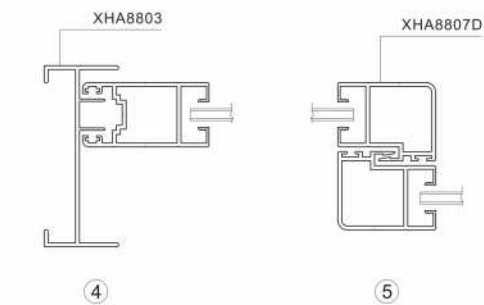
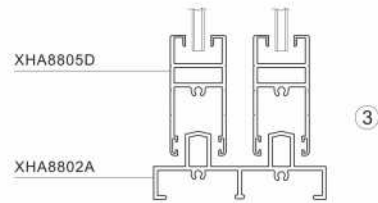
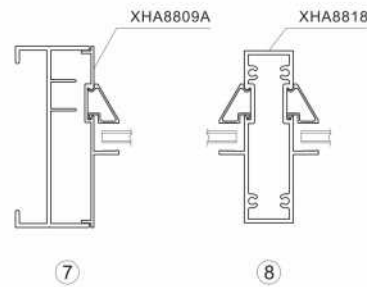
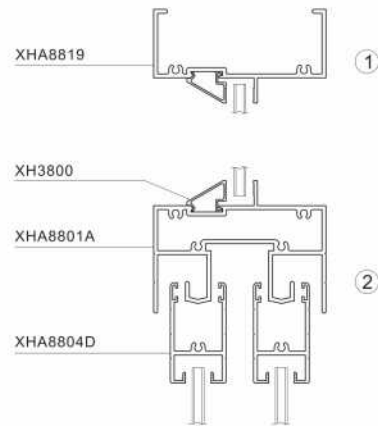
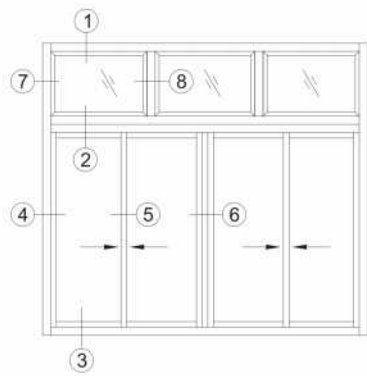

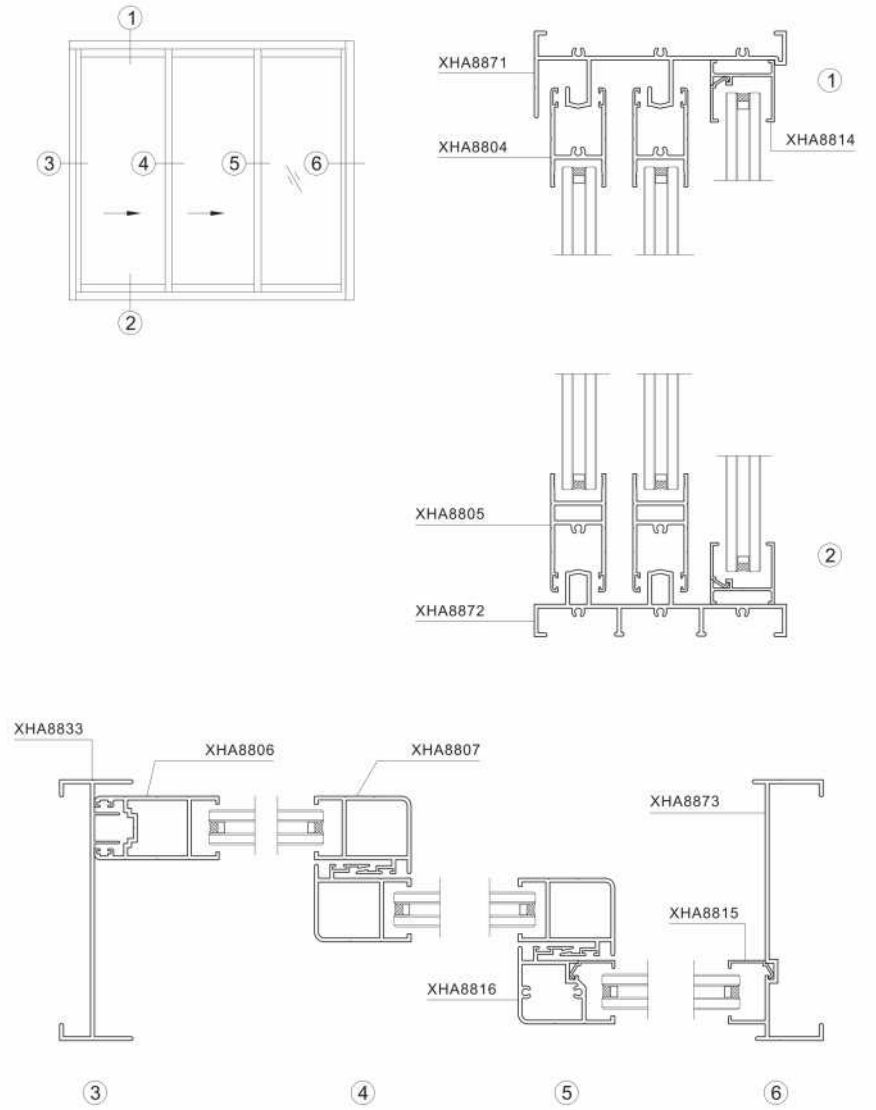
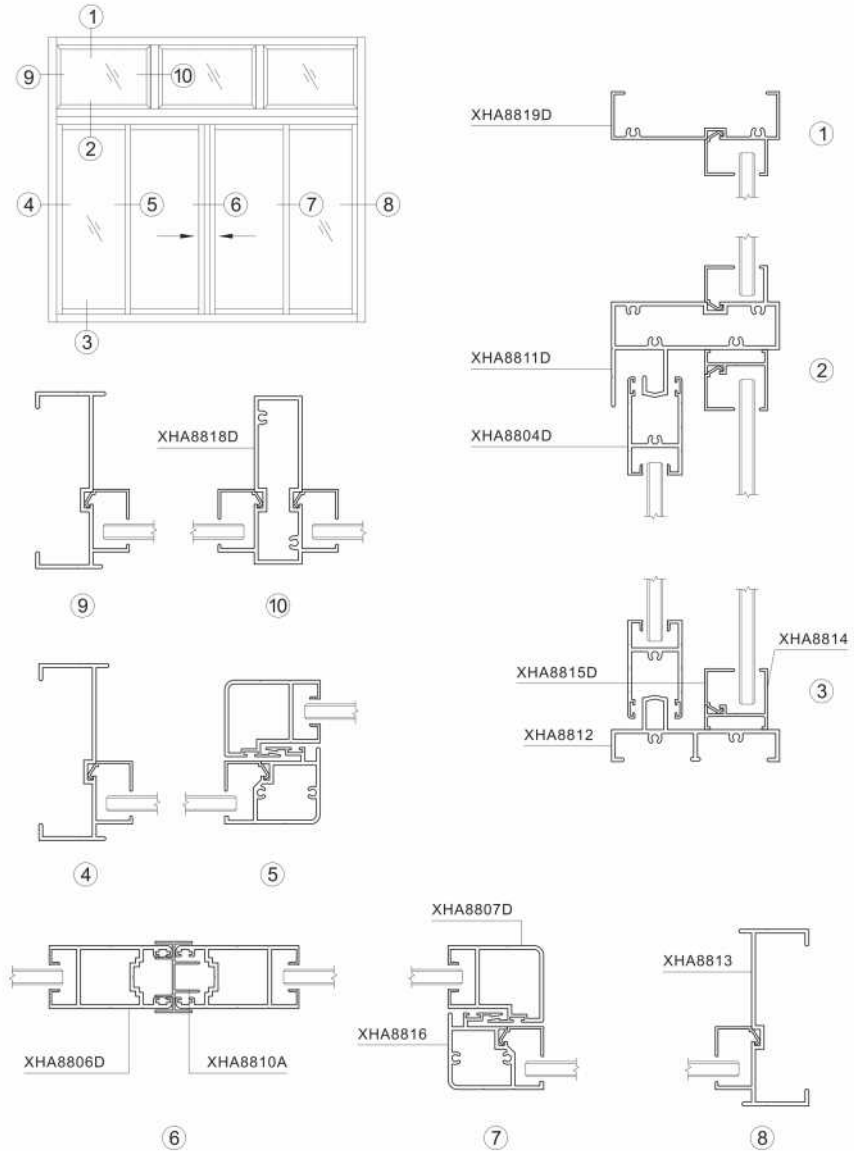

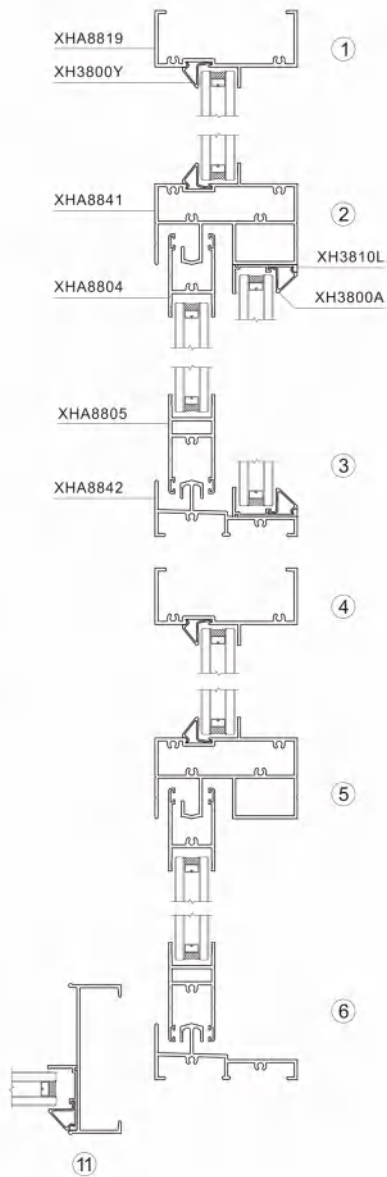
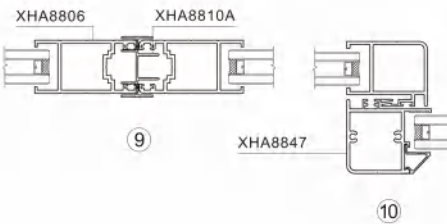
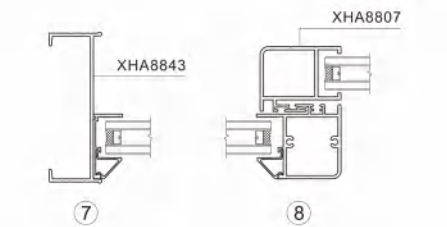
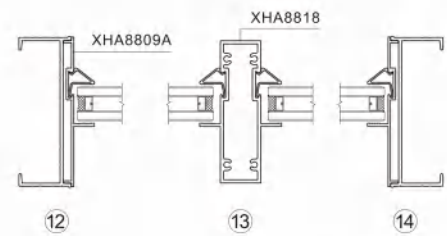
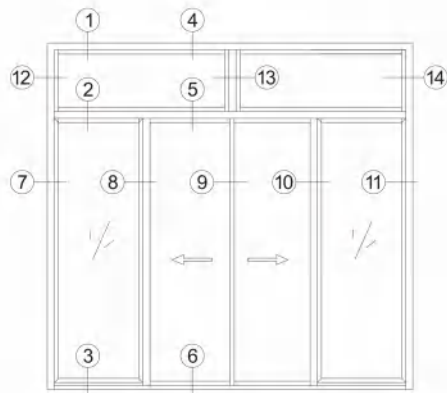

| 产品编号 | 产品图例 | 产品编号 | 产品图例 | 产品编号 | 产品图例 |
|---------------------------------|------|--------------------------------|------|--------------------------------|------|
| XHA8801 T=2.0mm 2.330kg/m | | XHA8801A T=2.0mm 2.330kg/m | | XHA8802 T=2.0mm 1.730kg/m | |
| 上滑 | | 上滑 | | 下滑 | |
| XHA8802A T=2.0mm 1.323kg/m | | XHA8802E T=2.0mm 1.420kg/m | | XHA8803 T=2.0mm 1.049kg/m | |
| 下滑 | | 下滑 | | 边封 | |
| XHA8804D T=2.0mm 0.800kg/m | | XHA8805D T=2.0mm 1.039kg/m | | XHA8804 T=2.0mm 0.737kg/m | |
| XHA8804DP T=1.4mm 0.635kg/m | | XHA8805DP T=1.4mm 0.809kg/m | | XHA8804CP T=1.5mm 0.604kg/m | |
| XHA8804DB T=1.25mm 0.575kg/m | | 上方(单玻) | | 上方(中空) | |
| XHA8805 T=2.0mm 0.979kg/m | | XHA8806D T=2.0mm 1.213kg/m | | XHA8806N T=1.85mm 1.519kg/m | |
| XHA8805CP T=1.5mm 0.790kg/m | | XHA8806M T=1.85mm 1.184kg/m | | 加强光企(单玻) | |
| XHA8842 | | 下方(中空) | | 加强光企(单玻) | |
| XHA8806JH T=2.0mm 1.605kg/m | | XHA8806DA T=2.0mm 1.714kg/m | | XHA8807D T=2.0mm 1.060kg/m | |
| 加强光企(单玻) | | 加强光企(单玻) | | XHA8807DP T=1.4mm 0.790kg/m | |
| XHA8807JH T=2.0mm 1.457kg/m | | XHA8806 T=2.0mm 1.167kg/m | | XHA8807G T=1.85mm 1.041kg/m | |
| 加强勾企(单玻) | | XHA8806CP T=1.5mm 0.896kg/m | | XHA8806F T=2.0mm 1.875kg/m | |
| XHA8806KH T=2.0mm 1.625kg/m | | XHA8806L T=2.0mm 1.760kg/m | | XHA8807 T=2.0mm 1.029kg/m | |
| 加强光企(中空) | | 加强光企(中空) | | XHA8807CP T=1.5mm 0.796kg/m | |
| XHA8807A T=2.0mm 1.576kg/m | | XHA8807KH T=2.0mm 1.504kg/m | | XHA8808 T=1.2mm 0.243kg/m | |
| 加强勾企(中空) | | 加强勾企(中空) | | 半玻璃 | |
| XHA8809 T=2.0mm 0.660kg/m | | XHA8809A T=1.4mm 0.493kg/m | | XHA8810A T=1.2mm 0.376kg/m | |
| 压线配: XH3800 XH3800Y | | 压线配: XH3800 XH3800Y | | 收口 | |
| 边封扣盖 | | 边封扣盖 | | | |



| 产品编号 | 产品图例 | 产品编号 | 产品图例 | 产品编号 | 产品图例 |
|---|------|---|------|---|------|
| XHA8811 T=2.0mm 1.166kg/m XHA8811B T=1.45mm 0.872kg/m | | XHA8811D T=2.0mm 1.937kg/m XHA8811DP T=1.8mm 1.780kg/m 压线配: XHA8815D | | XHA8812 T=2.0mm 1.101kg/m XHA8812B T=1.45mm 0.823kg/m XHA8812P T=1.8mm 1.022kg/m | |
| XHA8802M T=2.0mm 1.194kg/m | | XHA8813 T=2.0mm 1.099kg/m XHA8813A T=1.45mm 0.811kg/m XHA8813P T=1.8mm 1.011kg/m 压线配: XHA8815 XHA8815D | | XHA8814 T=1.4mm 0.333kg/m XHA8814P T=1.25mm 0.302kg/m 压线配: XHA8815 | |
| XHA8815 (单边凸线) T=1.2mm 0.109kg/m XHA8815Z (单边凸线) T=1.2mm 0.111kg/m 坡道口: 24.5mm | | XHA8815D T=2.0mm 0.152kg/m 坡道口: 13mm | | XHA8816 T=2.0mm 1.024kg/m XHA8816P T=1.8mm 0.947kg/m 压线配: XHA8815 XHA8815D | |
| XHA8816F T=2.0mm 1.533kg/m 压线配: XHA8815 | | XHA8816M T=2.0mm 1.138kg/m 压线配: XHA8815 | | XHA8818 T=2.0mm 1.599kg/m XHA8818P T=1.8mm 1.487kg/m 压线配: XH3800 XH3800Y | |
| XHA8818D T=2.0mm 1.602kg/m XHA8818DP T=1.8mm 1.478kg/m 压线配: XHA8815 XHA8815D | | XHA8819 T=2.0mm 1.095kg/m XHA8819P T=1.8mm 1.003kg/m 压线配: XH3800 XH3800Y | | XHA8819D T=1.4mm 0.780kg/m 压线配: XHA8815 XHA8815D | |
| XHA8824P T=1.2mm 0.799kg/m | | XHA8829 T=1.8mm 0.593kg/m 压线配: XH3800 XH3800Y | | XHA8841 T=1.9mm 2.221kg/m 压线配: XH3800Y | |
| XHA8842 T=1.9mm 1.130kg/m | | XHA8843 T=1.9mm 0.843kg/m | | XHA8847 T=1.9mm 1.072kg/m 压线配: XH3800A | |
| XHA8871 T=2.0mm 1.671kg/m | | XHA8872 T=2.0mm 1.686kg/m | | XHA8873 T=2.0mm 1.335kg/m | |
| XHA8833 T=2.0mm 1.284kg/m (NEW) | | XHA8875 T=1.8mm 0.520kg/m | | | |

| 产品编号 | 产品图例 | 产品编号 | 产品图例 | 产品编号 | 产品图例 |
|--------------------|------|---------------------|------|----------------------|------|
| XH3800Y XHA8841 | | XHA8847 XH3800A | | XHA8815 XHA8814 | |
| XHA8815 XHA8816 | | XHA8815D XHA8816 | | XH3800 XHA8818 | |
| XH3800A XHA8818 | | XHA8815 XHA8818D | | XHA8815D XHA8818D | |
| | | | | | |
| | | | | | |
| | | | | | |
| | | | | | |
| | | | | | |
| | | | | | |
| | | | | | |
| | | | | | |
| | | | | | |
| | | | | | |
| | | | | | |
| | | | | | |
| | | | | | |



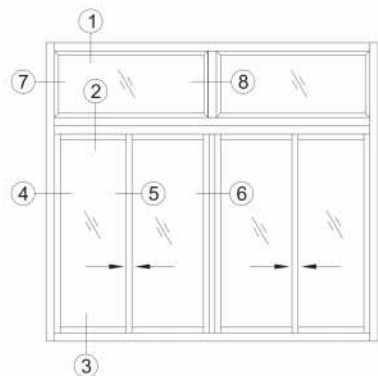

ZJM6103
角码配: GR6110

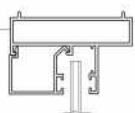

①

GR6104

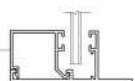

②

ZJM6101
角码配: GR6110

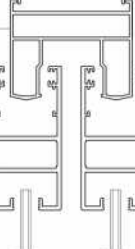

ZJM6102
活动角码配:
CCG01 (合和兴)

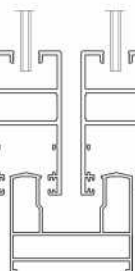

③

ZJM6104

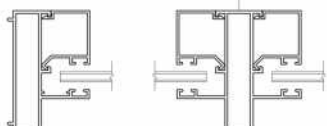

⑦

⑧

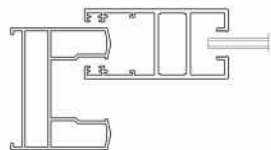

④

ZJM6106

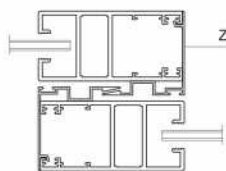

⑤

ZJM6105

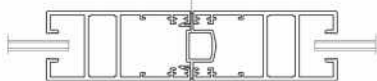

⑥

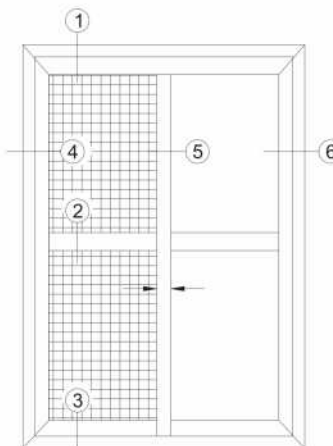

ZJM6130H
角码配: GR6110

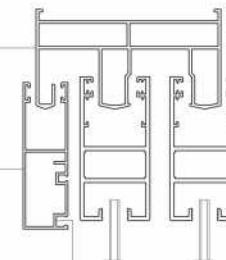

①

GR6131
角码配: ZJ4540

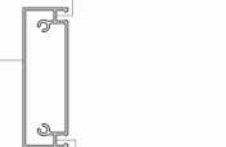

②

GR6132

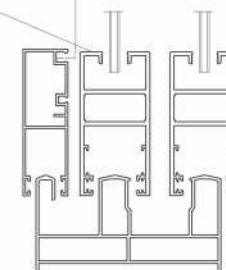

③

ZJM6102
活动角码配:
CCG01 (合和兴)

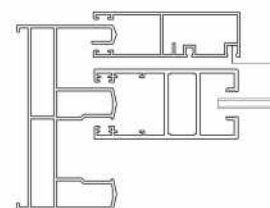
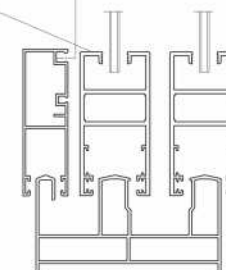

④

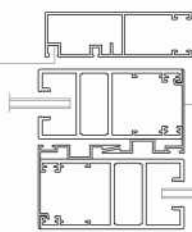

⑤

ZJM6106

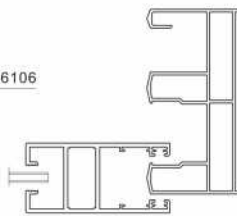

⑥



| 产品编号 | 产品图例 | 产品编号 | 产品图例 | 产品编号 | 产品图例 |
|--|------|--|------|--|------|
| ZJM6101 T=2.0mm 1.598kg/m 角码配: GR6110 ZJM6101P T=1.4mm 1.155kg/m | | ZJM6102 T=2.0mm 1.375kg/m ZJM6102P T=1.4mm 1.028kg/m 活动角码配: CCG01 (合和) | | ZJM6103 T=1.4mm 0.745kg/m 角码配: GR6110 | |
| 外框 | | 门扇 | | 外框 | |
| ZJM6104 T=1.4mm 0.882kg/m | | ZJM6105 T=1.4mm 0.304kg/m | | ZJM6106 T=1.0mm 0.299kg/m | |
| 中框 | | 收口 | | 匀板 | |
| ZJM6111L T=1.8mm 1.814kg/m 活动角码配: CCG01 (合和) | | ZJM6112L T=1.8mm 1.168kg/m 活动角码配: CCG01 (合和) | | ZJM6130H T=2.0mm 2.288kg/m 角码配: GR6110 | |
| 下滑 | | 门扇 | | 外框 (带纱) | |
| GR6132 T=1.2mm 0.734kg/m | | GR6131 T=1.2mm 0.732kg/m 角码配: ZJ4540 | | ZJM6131P T=1.4mm 1.815kg/m 角码配: GR6110 | |
| 纱中框 | | 纱料 | | 外框 (三轨) | |
| ZJM6132P T=1.4mm 0.686kg/m 角码配: GR6110 | | ZJM6107 T=1.0mm 0.211kg/m 玻璃口: 27mm | | ZJM6108 T=1.4mm 0.240kg/m | |
| 单外框 | | 压线 | | 铝槽 | |
| ZJM6130P T=1.4mm 1.624kg/m 角码配: GR6110 | | ZJM6115P T=1.4mm 1.004kg/m | | ZJM6133P T=1.4mm 0.904kg/m | |
| 外框 (带纱) | | 中框 | | 门扇 | |
| ZJM6134P T=1.4mm 0.676kg/m | | GR6104 T=1.2mm 0.277kg/m 玻璃口: 12.6mm | | | |
| 中框 | | 压线 | | | |
| | | | | | |
| | | | | | |

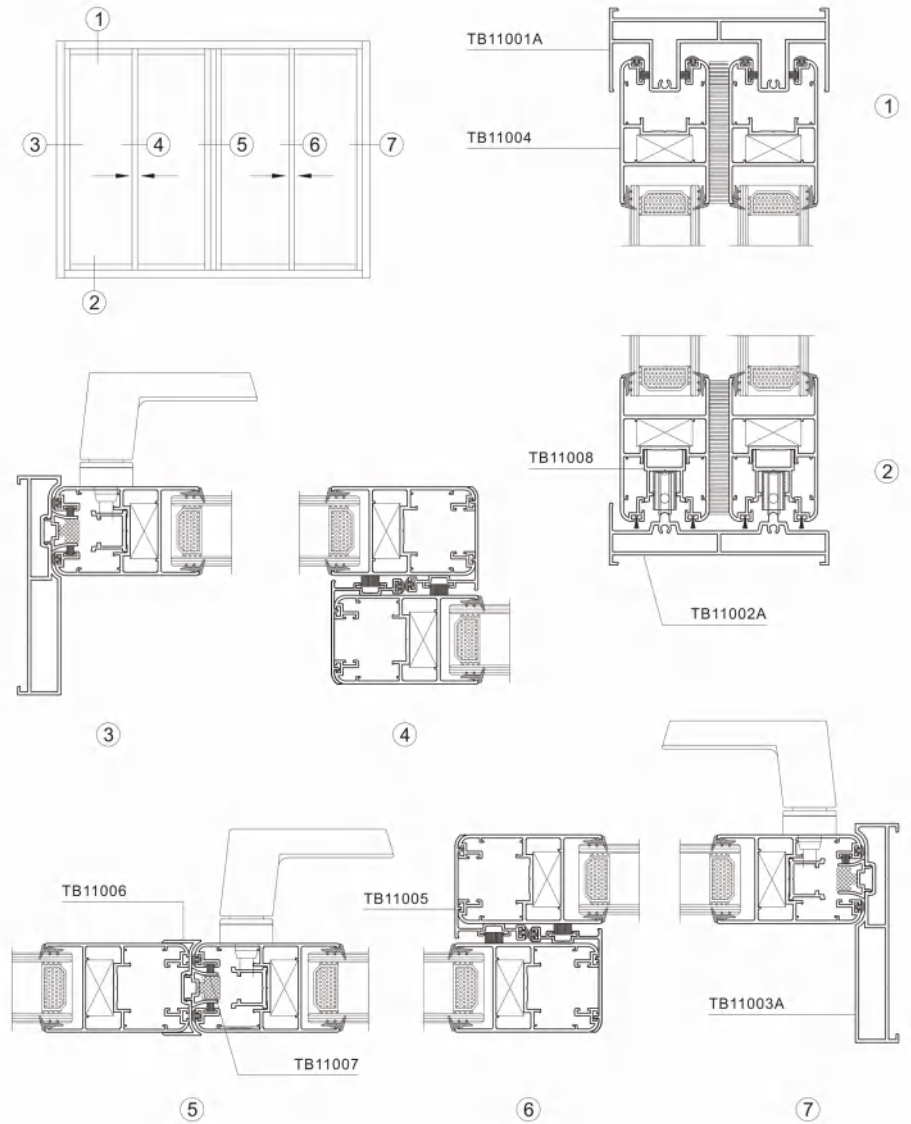

| 产品编号 | 产品图例 | 用途 | 产品编号 | 产品图例 | 用途 |
|-------------------------------|------|------|-------------------------------|------|----|
| TB11001A T=1.7mm 2.058kg/m | | 上滑 | TB11002A T=1.7mm 1.586kg/m | | 下滑 |
| TB11003A T=1.7mm 1.393kg/m | | 边封 | TB11004 T=1.7mm 1.441kg/m | | 门扇 |
| TB11005 T=1.5mm 0.447kg/m | | 勾板 | TB11006 T=1.5mm 0.399kg/m | | 收口 |
| TB11007 T=1.4mm 0.216kg/m | | 边封扣盖 | TB11008 T=1.5mm 0.342kg/m | | 辅料 |
| TB11009 T=1.2mm 0.386kg/m | | 玻璃槽 | TB11012 T=1.7mm 1.550kg/m | | 门扇 |
| | | | | | |
| | | | | | |
| | | | | | |

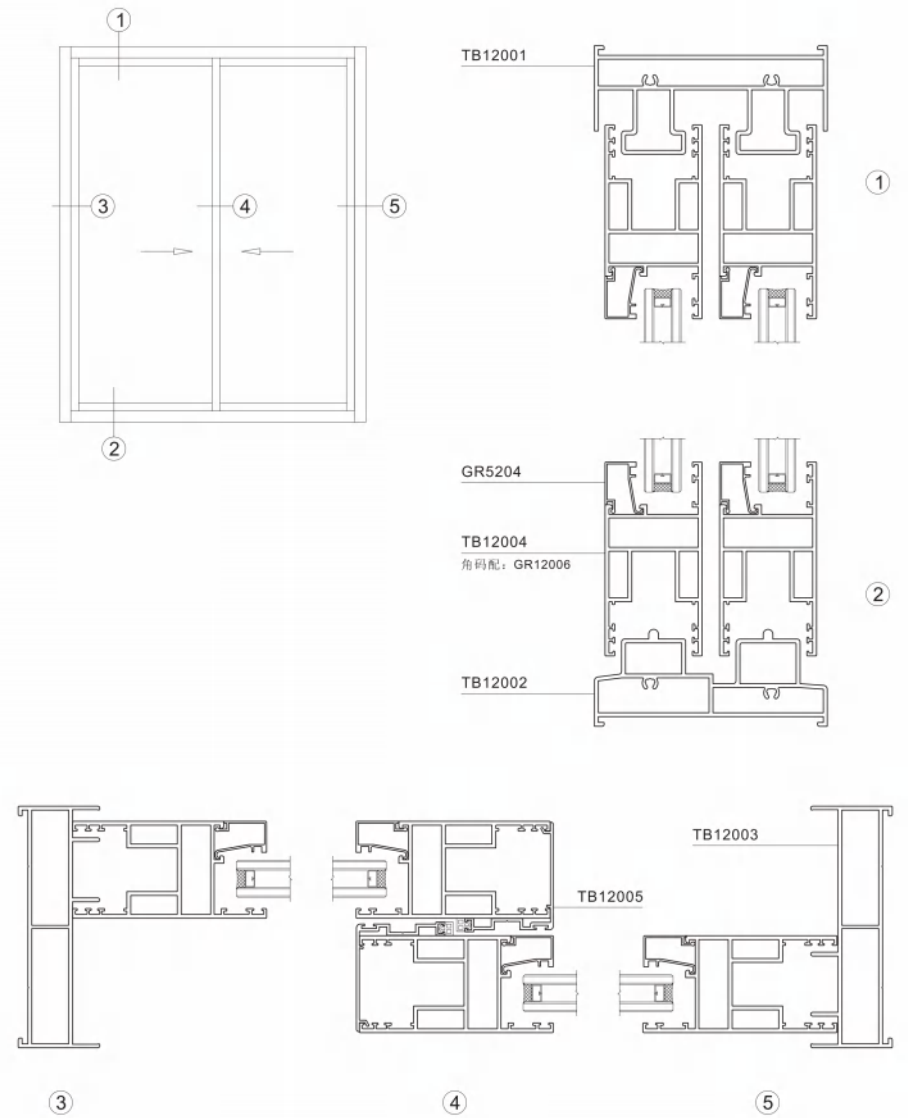

| 产品编号 | 产品图例 | 用途 | 产品编号 | 产品图例 | 用途 |
|---|------|----|---|------|----|
| TB12001 T=2.0mm 3.034kg/m | | 上滑 | TB12002 T=2.0mm 2.649kg/m | | 下滑 |
| TB12003 T=2.0mm 2.024kg/m | | 边封 | TB12004 T=2.0mm 2.042kg/m 压线配: GR5204 角码配: GR12006 | | 门扇 |
| TB12005 T=1.5mm 0.528kg/m | | 勾企 | GR5204 T=1.0mm 0.232kg/m 配: TB12004 | | 压线 |
| TB12007 T=2.0mm 0.443kg/m | | 配件 | TB12008 T=2.0mm 1.124kg/m 压线配: GR5204 | | 上固 |
| TB12009 T=2.0mm 1.473kg/m 压线配: GR5204 | | 上固 | TB12010 T=2.0mm 2.162kg/m 压线配: GR5204 | | 中柱 |
| | | | | | |
| | | | | | |
| | | | | | |

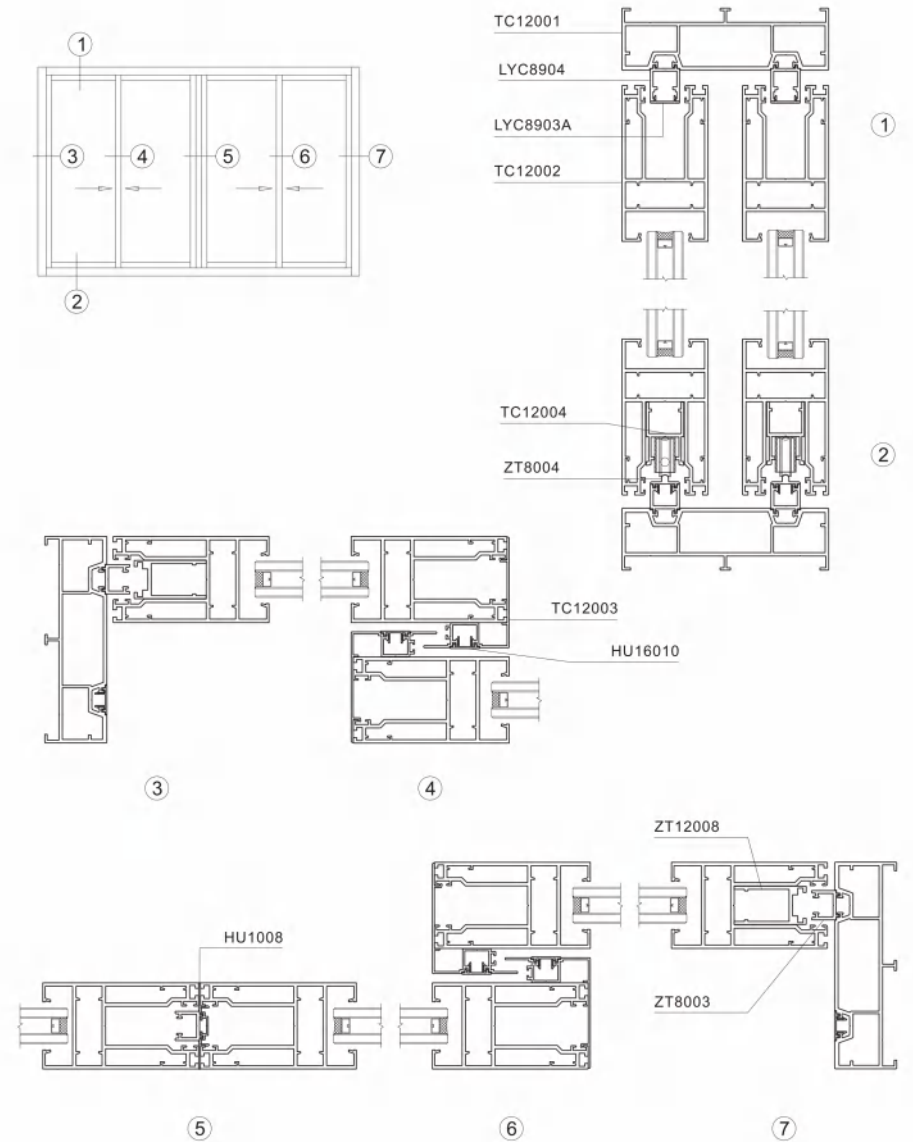

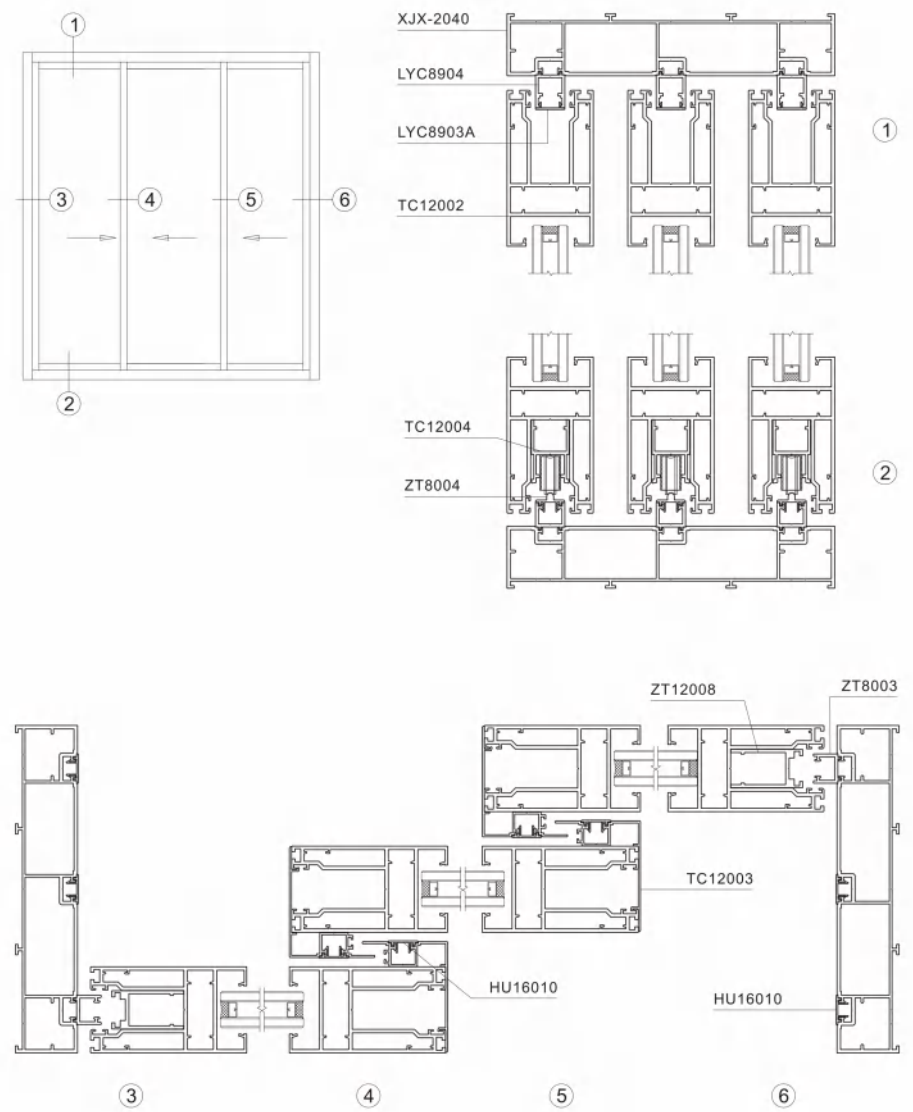
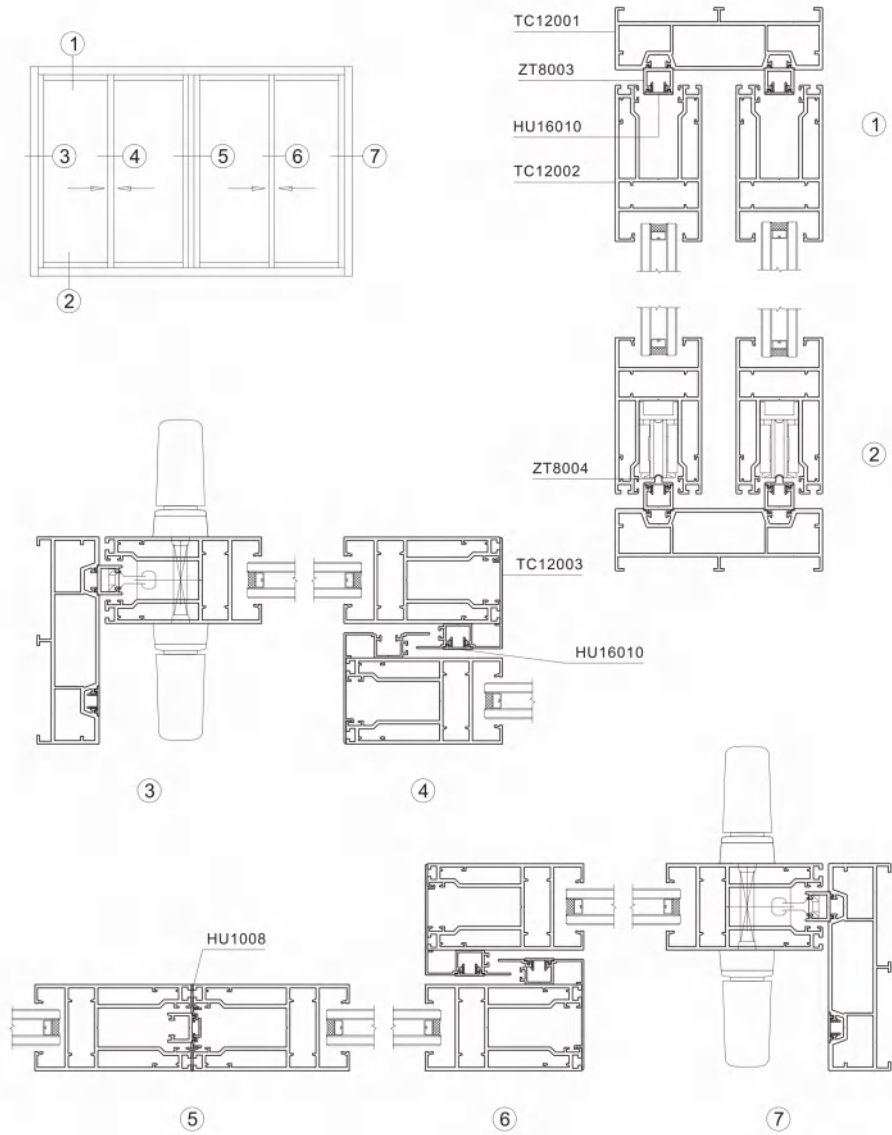

| 产品编号 | 产品图例 | 用途 | 产品编号 | 产品图例 | 用途 |
|---|------|------|---|------|------|
| TC12001 T=2.0mm 2.055kg/m 配: ZT8003 ZT8004 | | 外框 | TC12002 T=2.0mm 2.368kg/m 配: HU1008 | | 扇料 |
| TC12003 T=1.2mm 0.537kg/m 配: HU16010 | | 勾企 | TC12002A T=2.0mm 2.836kg/m 配: HU1007A HU1008 | | 扇料 |
| TC12004 T=1.5mm 0.430kg/m | | 扇料辅件 | ZT8003 T=1.8mm 0.233kg/m | | 外框辅件 |
| HU16010 T=1.0mm 0.100kg/m | | 盖板 | HU1008 T=1.0mm 0.194kg/m 配: HU1002 HU1003 | | 盖板 |
| LYC8904 T=1.6mm 0.265kg/m 配: LYC8903A | | 外框辅件 | LYC8903A T=1.0mm 0.060kg/m 配: LYC8904 | | 盖板 |
| XJX-2040 T=2.0mm 2.867kg/m | | 外框 | ZT8004 T=1.0mm 0.130kg/m 配: ZT8003 ZT8001 ZT12001 | | 轨道 |
| ZT12008 T=1.8mm 0.577kg/m | | 扇料辅件 | | | |

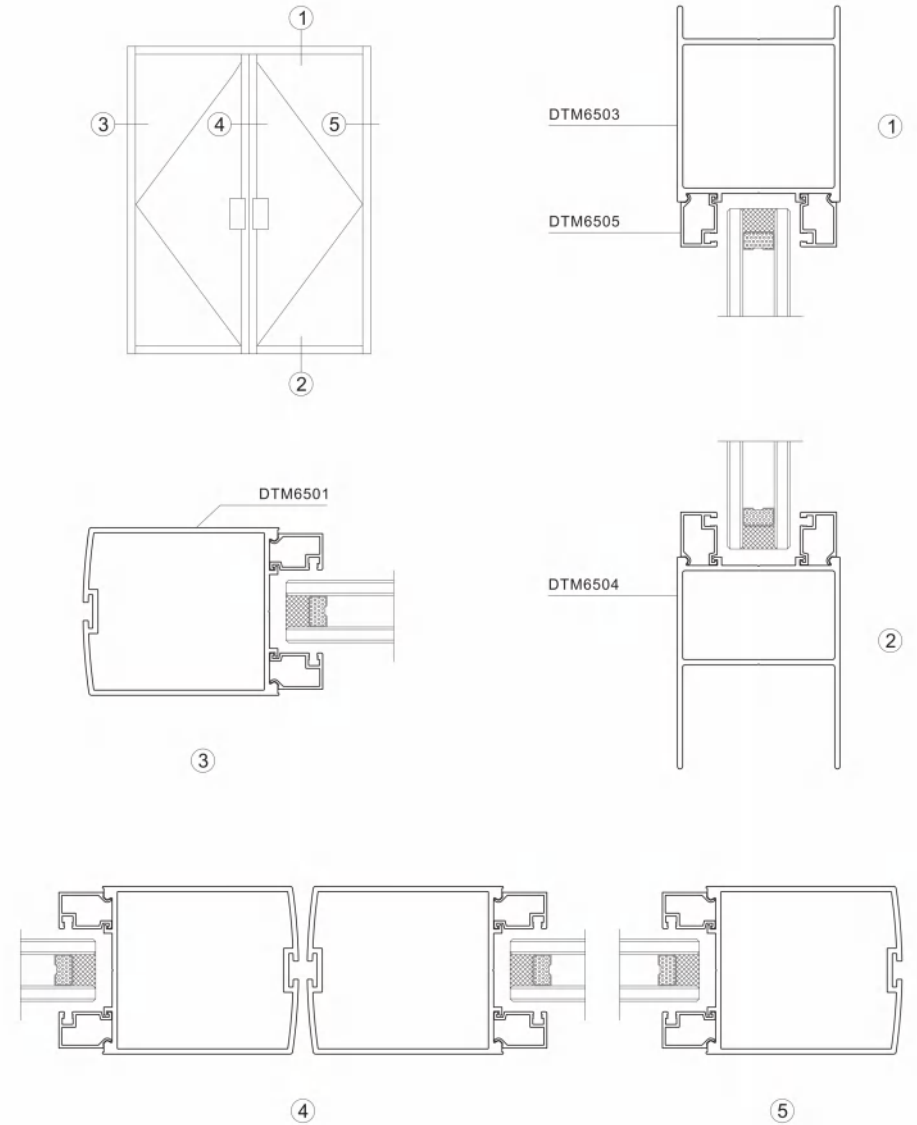

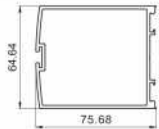
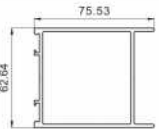
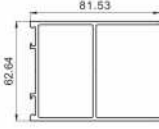
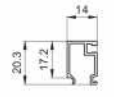
| 产品编号 | 产品图例 | 用途 | 产品编号 | 产品图例 | 用途 |
|--|---|-----|--|---|-----|
| DTM6501 T=2.0mm 1.615kg/m 压线配: DTM6505 |  | 门整料 | DTM6503 T=2.1mm 1.600kg/m 压线配: DTM6505 |  | 门上横 |
| DTM6504 T=2.0mm 1.597kg/m 压线配: DTM6505 |  | 门下横 | DTM6505 T=1.1mm 0.192kg/m |  | 压线 |
| | | | | | |
| | | | | | |
| | | | | | |
| | | | | | |
| | | | | | |
| | | | | | |

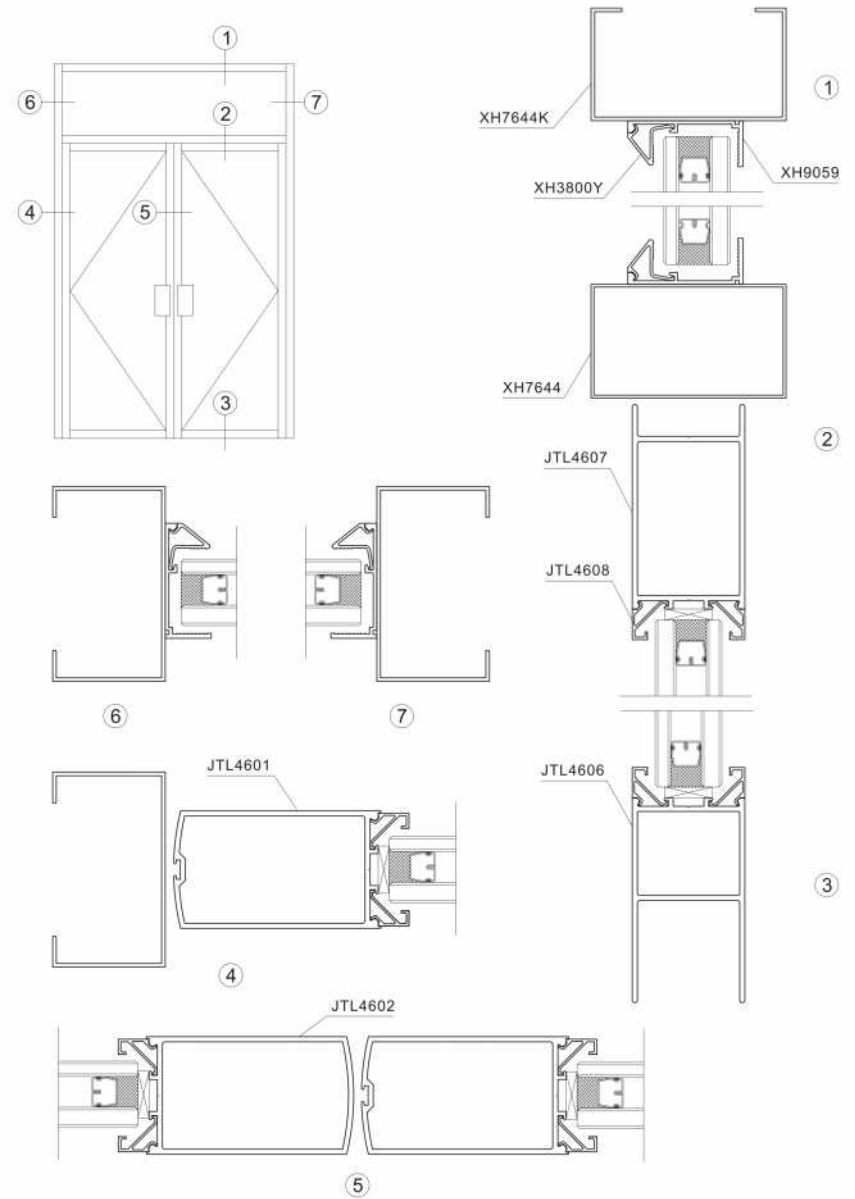

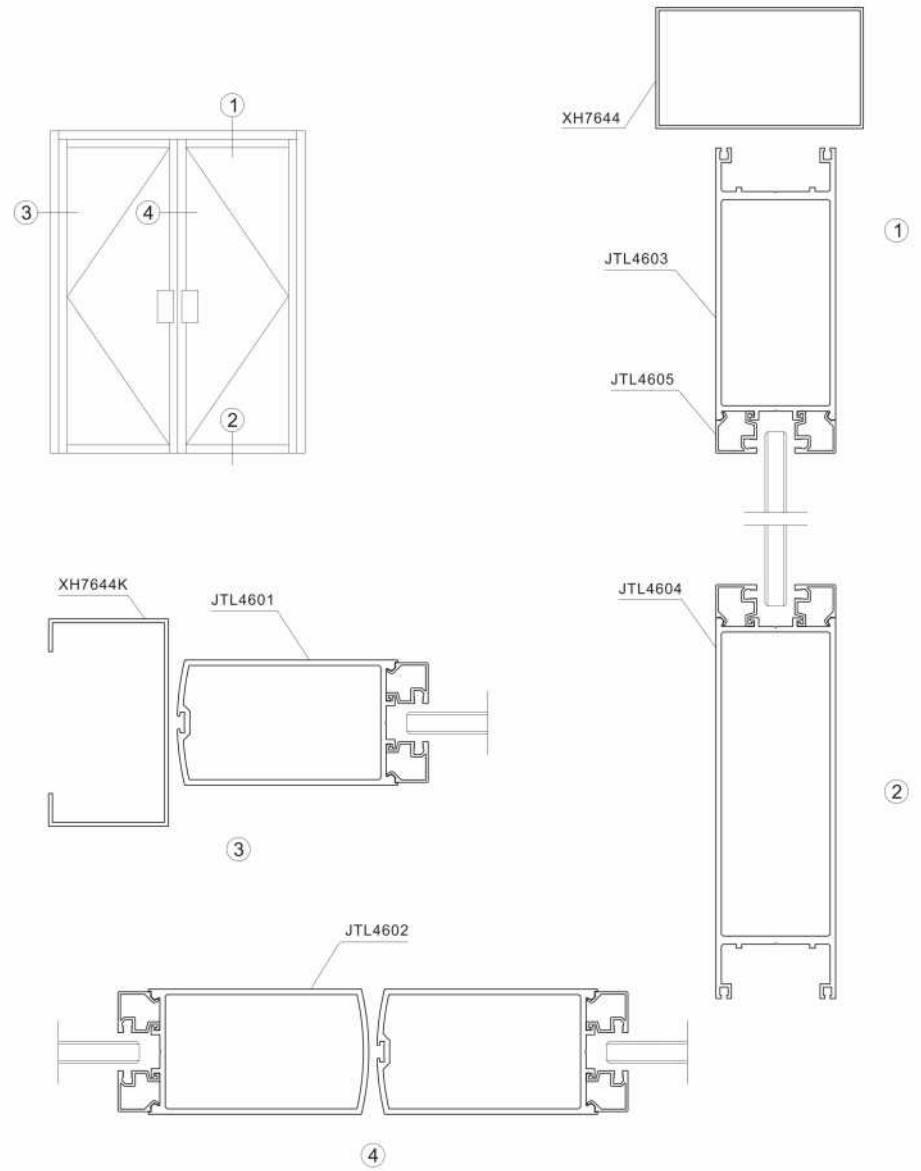
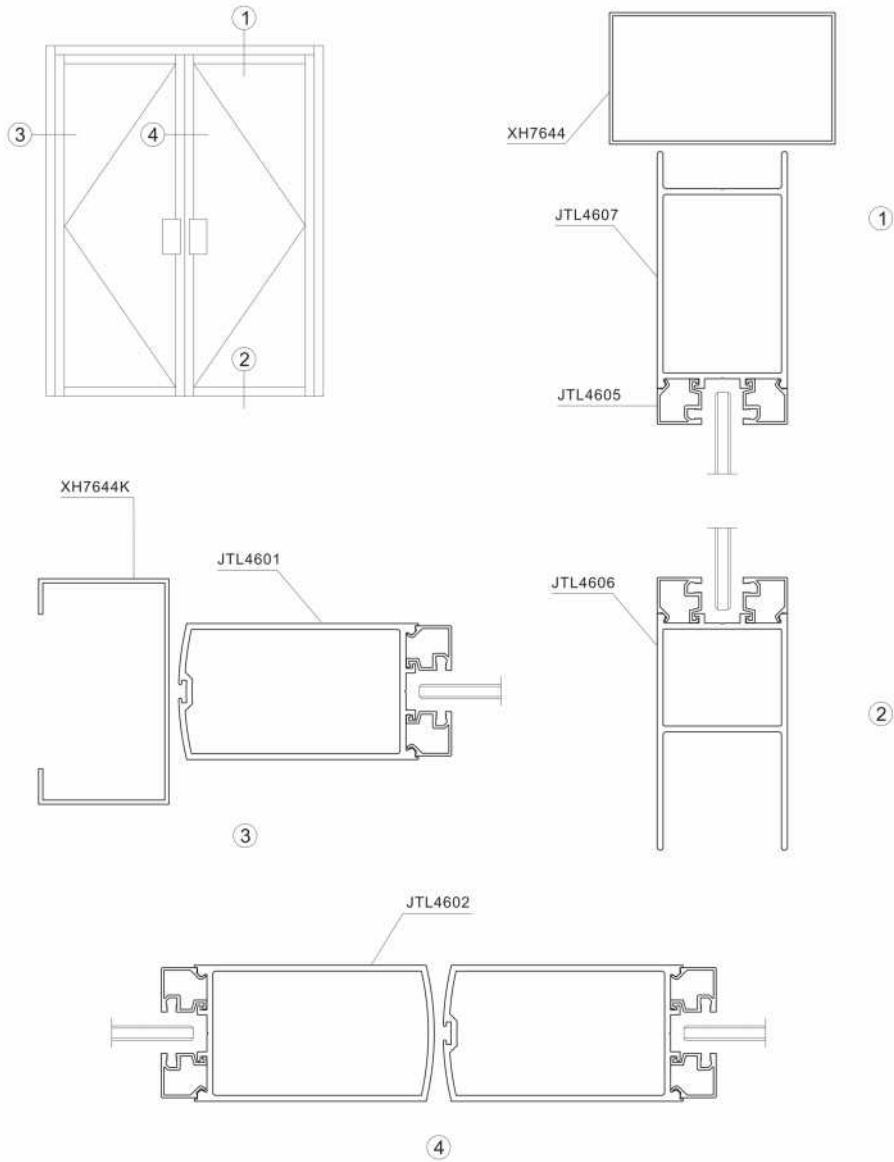

| 产品编号 | 产品图例 | 用途 | 产品编号 | 产品图例 | 用途 |
|---|------|-----|--|------|-----|
| JTL4601 T=2.0mm 1.397kg/m | | 门整料 | JTL4602 T=2.0mm 1.368kg/m | | 门整料 |
| JTL4603 T=2.0mm 1.741kg/m | | 门上横 | JTL4604 T=2.0mm 2.176kg/m | | 门下横 |
| JTL4605 T=0.9mm 0.151kg/m 玻璃口: 16mm | | 压线 | JTL4606 T=2.0mm 1.351kg/m | | 门下横 |
| JTL4606A T=2.0mm 1.455kg/m | | 门上横 | JTL4607 T=2.0mm 1.353kg/m | | 门整料 |
| JTL4608 T=1.0mm 0.101kg/m 玻璃口: 32mm | | 压线 | JTL4608A T=1.0mm 0.110kg/m 玻璃口: 25mm | | 压线 |
| JTL4609 T=0.8mm 0.100kg/m 玻璃口: 16mm | | 压线 | JTL4608E T=1.0mm 0.128kg/m 玻璃口: 20mm | | 压线 |
| JTL4612 T=2.0mm 1.406kg/m | | 门整料 | JTL4613 T=2.0mm 1.649kg/m | | 门下横 |
| JTL4614 T=2.0mm 1.284kg/m | | 门下横 | JTL4615 T=1.0mm 0.127kg/m 玻璃口: 29mm | | 压线 |

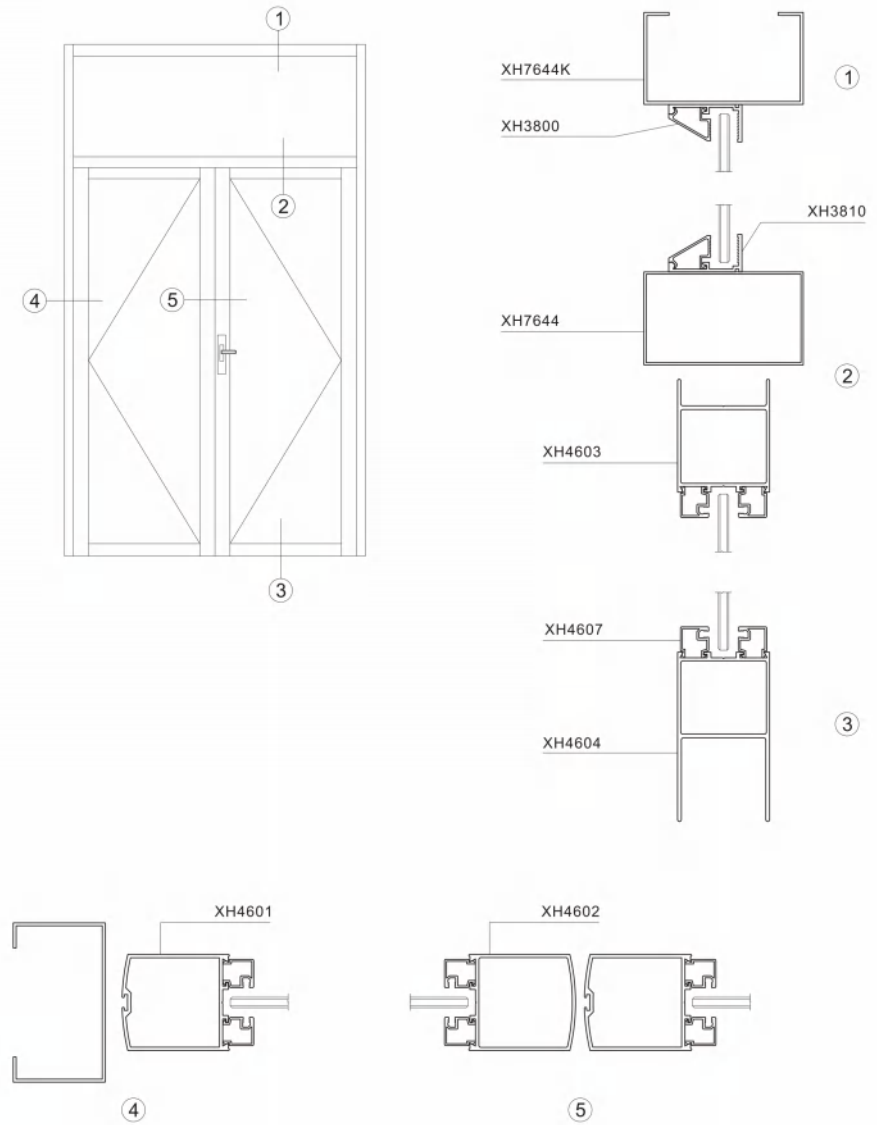

| 产品编号 | 产品图例 | 产品编号 | 产品图例 | 产品编号 | 产品图例 |
|---|------|---|------|---|------|
| XH4601 T=1.6mm 0.879kg/m XH4601P T=1.2mm 0.760kg/m XH4601H T=2.0mm 1.050kg/m 压线配: XH4606 XH4607 XH4612 | | XH4602 T=1.5mm 0.796kg/m XH4602P T=1.2mm 0.663kg/m XH4602H T=2.0mm 1.030kg/m 压线配: XH4606 XH4607 XH4612 | | XH4603 T=1.5mm 0.848kg/m XH4603P T=1.3mm 0.717kg/m XH4603H T=2.0mm 1.056kg/m 压线配: XH4606 XH4607 XH4612 | |
| 门竖料 | | 门竖料 | | 门上横 | |
| XH4604 T=1.5mm 1.132kg/m XH4604P T=1.2mm 0.885kg/m XH4604H T=2.0mm 1.351kg/m 压线配: XH4606 XH4607 XH4612 | | XH4605 T=2.5mm 1.426kg/m | | XH4606 T=0.9mm 0.121kg/m 玻璃口: 14.2mm | |
| 门下横 | | 拉手 | | 压线 | |
| XH4607 (氧化专用横) T=0.9mm 0.145kg/m XH4607Z (喷涂专用横) T=0.9mm 0.141kg/m 玻璃口: 14.2mm | | XH4608 T=3.2mm 2.494kg/m XH4608P T=1.8mm 1.464kg/m | | XH4609 T=1.3mm 0.867kg/m 压线配: XH4606 XH4607 XH4612 | |
| 压线 | | 自动门料 | | 中横 | |
| XH4609A T=1.3mm 0.688kg/m 压线配: XH4606 XH4607 XH4612 | | XH4610 T=1.6mm 1.172kg/m XH4610P T=1.3mm 0.980kg/m XH4610H T=2.0mm 1.434kg/m 压线配: XH4606 XH4607 XH4612 | | XH4612 T=1.0mm 0.106kg/m 玻璃口: 21mm | |
| 中横 | | 门竖料 | | 压线 | |
| XH4612K T=0.9mm 0.103kg/m 玻璃口: 21mm | | XH4612X T=0.9mm 0.098kg/m 氧化专用横 玻璃口: 30mm | | XH4627 T=0.8mm 0.090kg/m (喷涂专用横) 玻璃口: 25.6mm | |
| 压线 | | 压线 | | 压线 | |
| XH4601CH T=1.4mm 0.986kg/m 压线配: XH4606 XH4607 XH4612 | | XH4602CH T=1.4mm 0.951kg/m 压线配: XH4606 XH4607 XH4612 | | XH4604CH T=1.4mm 0.975kg/m 压线配: XH4606 XH4607 XH4612 | |
| 门竖料 | | 门竖料 | | 门下横 | |
| XH4625 T=2.0mm 1.367kg/m 压线配: XH4606 XH4607 XH4612 | | XH4625 T=2.0mm 1.367kg/m 压线配: XH4606 XH4607 XH4612 | | XH4611 T=1.6mm 1.567kg/m 压线配: XH4606 XH4607 XH4612 | |
| 门竖料 | | 门竖料 | | 门下横 | |
| XH4623 T=1.9mm 1.911kg/m 压线配: GR11005A GR11005 GR1105B | | XH4626 T=1.9mm 1.584kg/m 压线配: GR11005A GR11005 GR1105B | | GR11005 T=1.0mm 0.171kg/m 玻璃口: 31.4mm | |
| 双面管 | | 单面管 | | 压线 | |
| GR11005A T=1.0mm 0.181kg/m 玻璃口: 18.4mm | | GR11005B T=1.0mm 0.225kg/m 玻璃口: 16.4mm | | | |
| 压线 | | 压线 | | | |

| 产品编号 | 产品图例 | 产品编号 | 产品图例 | 产品编号 | 产品图例 |
|-------------------|------|------------------|------|-------------------|------|
| GR11005 XH4623 | | XH4606 XH4603 | | XH4607 XH4603 | |
| | | | | | |
| XH4612 XH4603 | | XH4627 XH4603 | | XH4612K XH4603 | |
| | | | | | |
| XH4612X XH4603 | | | | | |
| | | | | | |
| | | | | | |
| | | | | | |
| | | | | | |
| | | | | | |
| | | | | | |
| | | | | | |
| | | | | | |
| | | | | | |
| | | | | | |
| | | | | | |
| | | | | | |
| | | | | | |
| | | | | | |



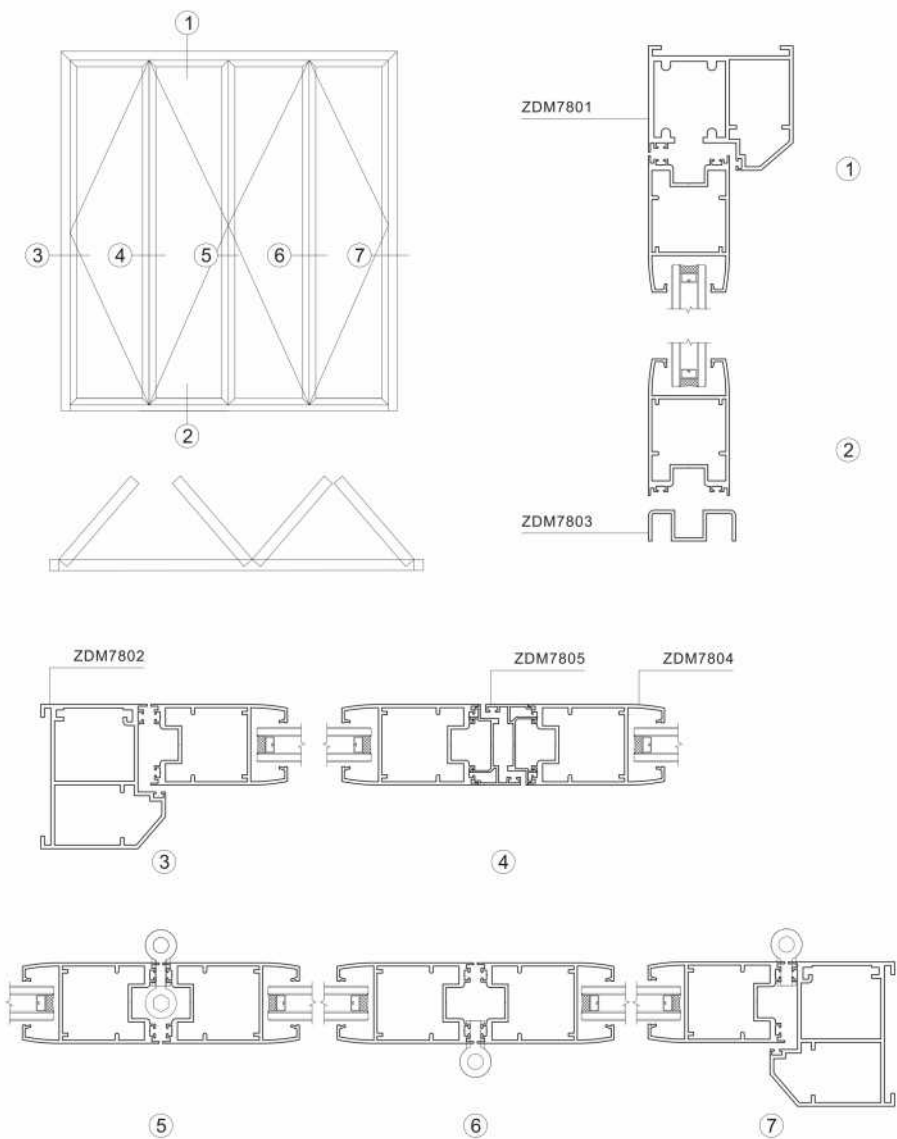

| 产品编号 | 产品图例 | 用途 | 产品编号 | 产品图例 | 用途 |
|--|------|-----|-------------------------------|------|----|
| ZDM7801 T=2.0mm 2.336kg/m | | 上吊轨 | ZDM7802 T=2.0mm 2.019kg/m | | 边框 |
| ZDM7803 T=1.8mm 0.517kg/m | | 下吊轨 | ZDM7804 T=1.8mm 1.457kg/m | | 门扇 |
| ZDM7805 T=1.2mm 0.353kg/m 配: ZDM7804 | | 收口 | ZDM7804F T=1.8mm 1.523kg/m | | 门扇 |
| | | | | | |
| | | | | | |
| | | | | | |
| | | | | | |
| | | | | | |
| | | | | | |



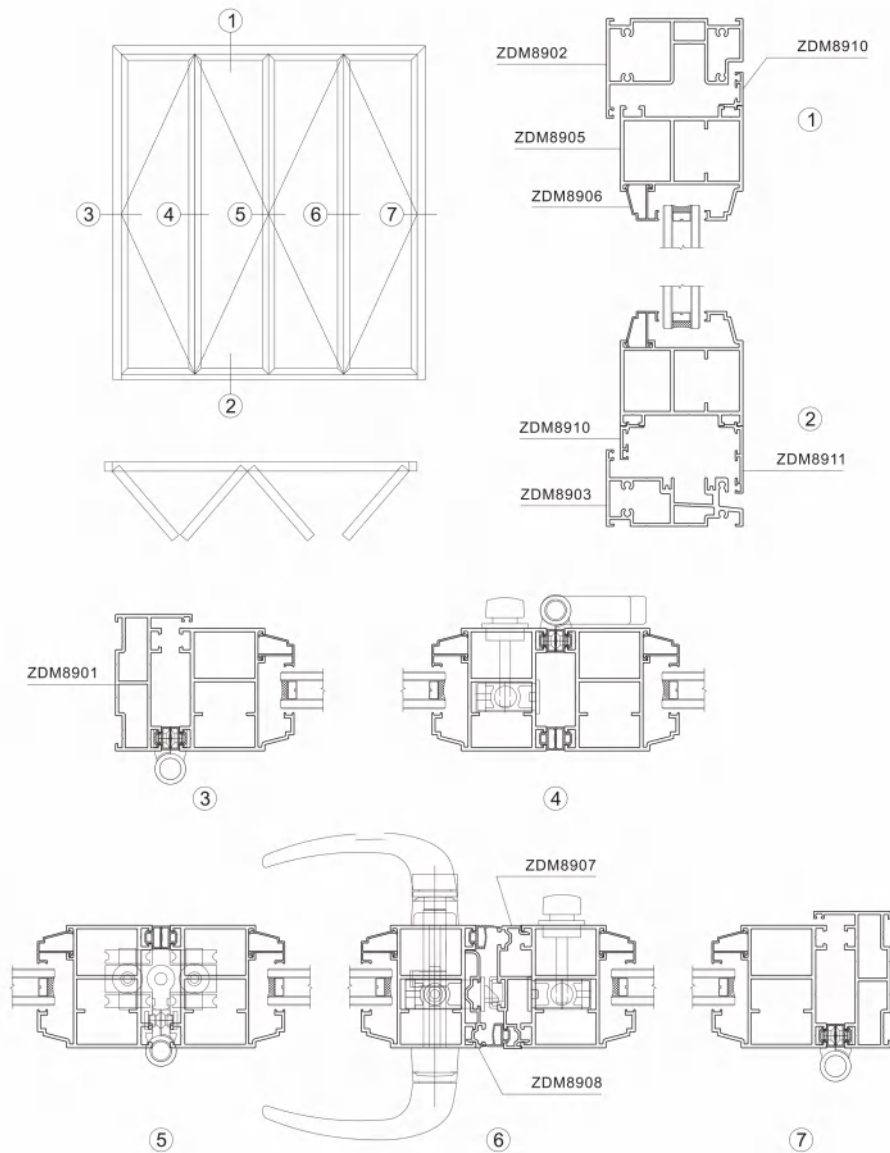

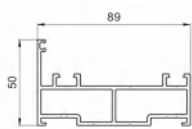
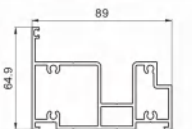
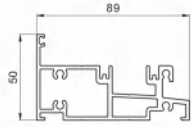
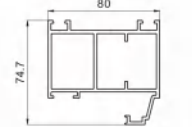
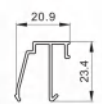
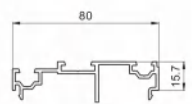
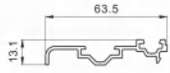
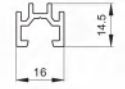
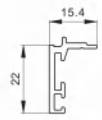
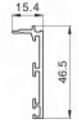
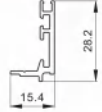
| 产品编号 | 产品图例 | 用途 | 产品编号 | 产品图例 | 用途 |
|------------------------------|--|----|------------------------------|---|----|
| ZDM8901 T=2.0mm 1.700kg/m |  | 边封 | ZDM8902 T=2.0mm 2.205kg/m |  | 上固 |
| ZDM8903 T=2.0mm 2.060kg/m |  | 下固 | ZDM8905 T=2.0mm 2.307kg/m |  | 扇料 |
| ZDM8906 T=1.0mm 0.198kg/m |  | 压线 | ZDM8907 T=1.6mm 0.787kg/m |  | 盖板 |
| ZDM8908 T=1.6mm 0.467kg/m |  | 盖板 | ZDM8909 T=1.6mm 0.219kg/m |  | 杂料 |
| ZDM8910 T=1.8mm 0.221kg/m |  | 杂料 | ZDM8911 T=1.8mm 0.360kg/m |  | 杂料 |
| ZDM8912 T=1.8mm 0.243kg/m |  | 杂料 | | | |
| | | | | | |
| | | | | | |

